

Plan

POSSIBLE TYP. CENTER CONFIGURATIONS FOLLOW ON PAGES 2 OF 5 THROUGH 5 OF 5.

LOCATE 30" X 30" PANEL (ORIENT AS DESIRED)

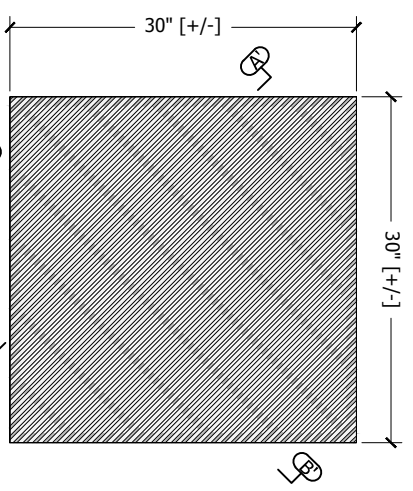

30" x 30" TYP. PANEL

Section B-B'

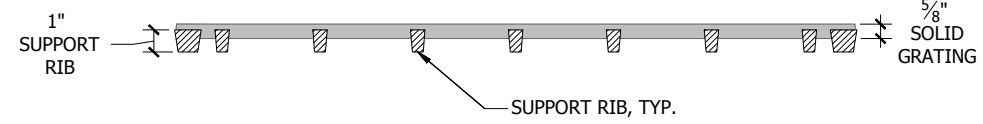
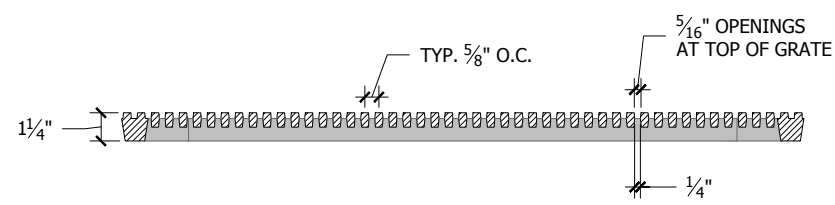

Section A-A'

SPECIFICATIONS

- Material will be high quality 100% recycled grey iron; ASTM A48 class 35b or better; hardness 170-223 brinnell (unless specified otherwise; see below).

Material:

- Grey iron ASTM A48 (standard)
- Aluminum, ASTM B26
- Ductile iron, (required for all load ratings higher than pedestrian) ASTM A536 class 65-45-12.
- Nickel bronze (ASTM B30)
- Bronze (ASTM B26)

- Finish will be natural patina of raw iron (unless specified otherwise; see below).

Finish:

- Raw (standard)
 - Rust conditioner
 - Polyester Powder Coat*
 - Liquid Coat (wet paint)*
- Color:
- *Please specify standard UA color or mfr. name and color code.
 - Brush (bronze/nickel/aluminum only)
 - Polish (bronze/nickel/aluminum only)
 - Galvanized (grey iron and ductile iron only)
 - Other:

- Dimensions are nominal.

Notes

- 1) Cast in eight pieces.
- 2) Grate is 1 1/4" thick at edge.
- 3) Center opening expansion at 24 1/2" and 33".
- 4) No openings greater than 1/2", in conformance with ADA Accessibility Guidelines.

Comments:

Tree Grate

5' x 10' Variations

Page 1 of 5 Date: 3/31/14



465 E. FIFTEENTH ST. sales@urbanaccessories.com
TACOMA, WA 98421 www.urbanaccessories.com
(877) 487-0488

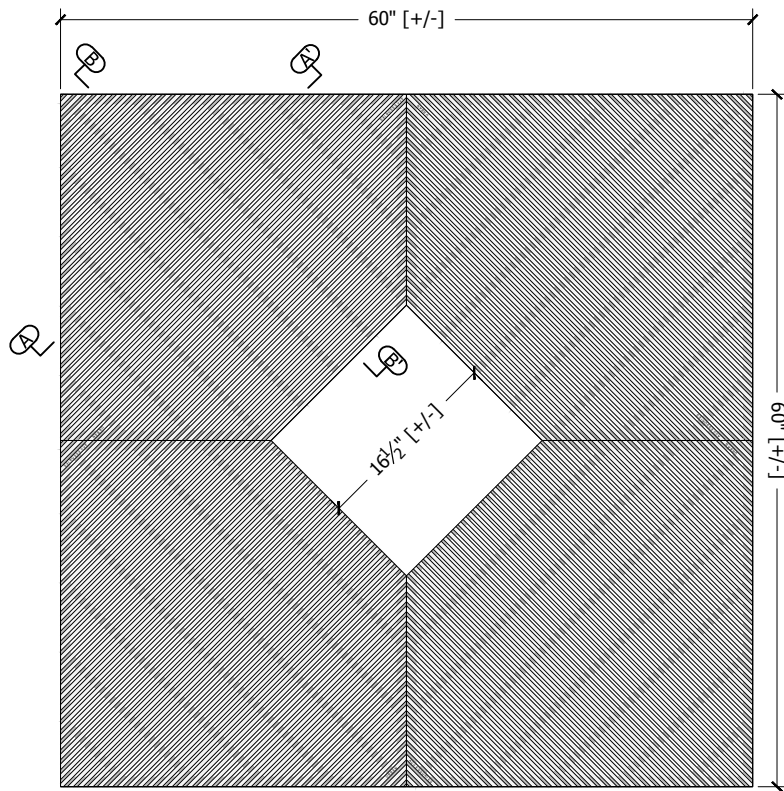

Plan

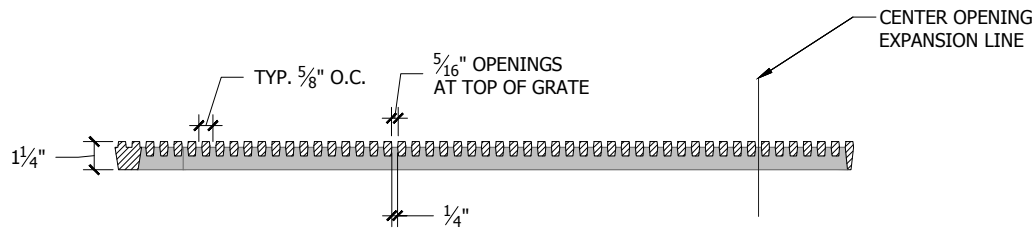

Section B-B'

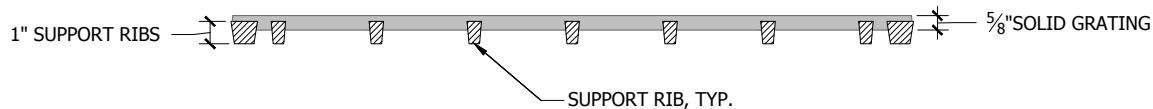

Section A-A'

SPECIFICATIONS

- Material will be high quality 100% recycled grey iron; ASTM A48 class 35b or better; hardness 170-223 brinnell (unless specified otherwise; see below).

Material:

- Grey iron ASTM A48 (standard)
- Aluminum, ASTM B26
- Ductile iron, (required for all load ratings higher than pedestrian) ASTM A536 class 65-45-12.
- Nickel bronze (ASTM B30)
- Bronze (ASTM B26)

- Finish will be natural patina of raw iron (unless specified otherwise; see below).

Finish:

- Raw (standard)
 - Rust conditioner
 - Polyester Powder Coat*
 - Liquid Coat (wet paint)*
- Color:
- *Please specify standard UA color or mfr. name and color code.
 - Brush (bronze/nickel/aluminum only)
 - Polish (bronze/nickel/aluminum only)
 - Galvanized (grey iron and ductile iron only)
 - Other:

- Dimensions are nominal.

Notes

- 1) Cast in four pieces.
- 2) Grate is 1 1/4" thick at edge.
- 3) Center opening expansion at 24 1/2" and 33".
- 4) No openings greater than 1/2", in conformance with ADA Accessibility Guidelines.

Comments:

Tree Grate

5' Sq. Variations
Configuration Arrow

Page 2 of 5 Date: 3/31/14



465 E. FIFTEENTH ST. sales@urbanaccessories.com
TACOMA, WA 98421 www.urbanaccessories.com
(877) 487-0488

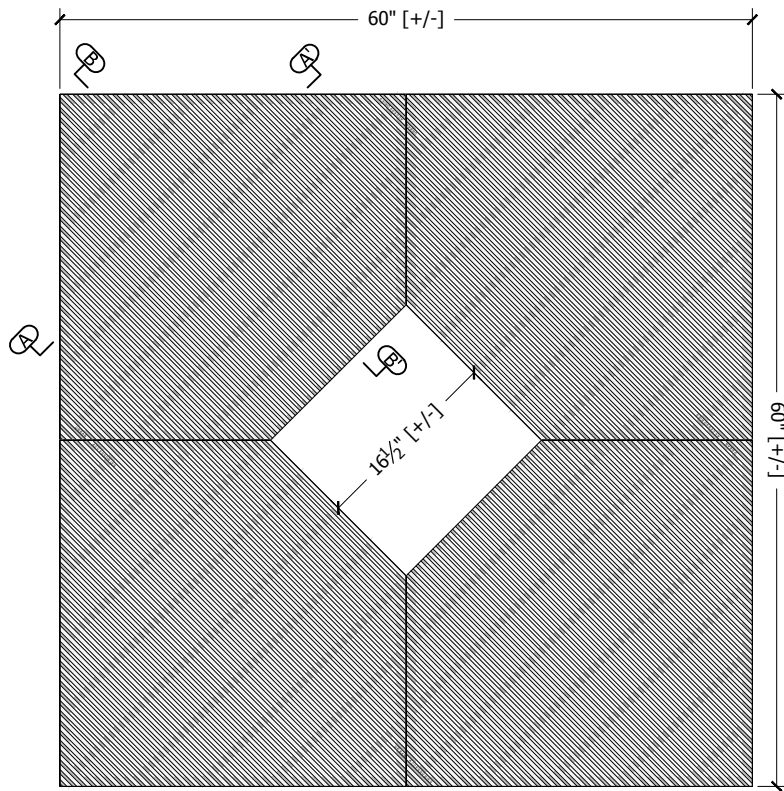

Plan

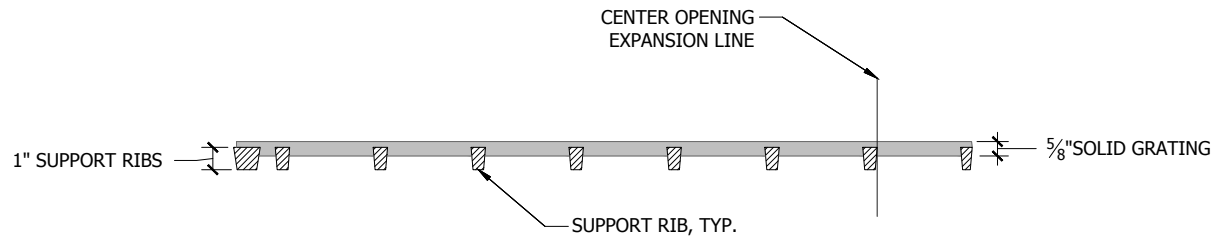

Section B-B'

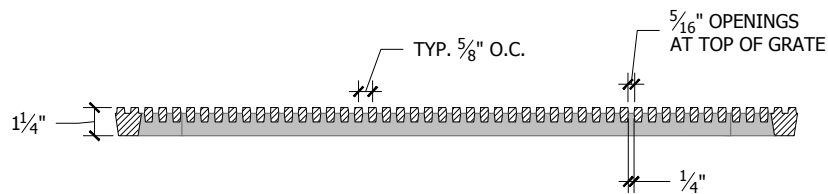

Section A-A'

SPECIFICATIONS

- Material will be high quality 100% recycled grey iron; ASTM A48 class 35b or better; hardness 170-223 brinnell (unless specified otherwise; see below).

Material:

- Grey iron ASTM A48 (standard)
- Aluminum, ASTM B26
- Ductile iron, (required for all load ratings higher than pedestrian) ASTM A536 class 65-45-12.
- Nickel bronze (ASTM B30)
- Bronze (ASTM B26)

- Finish will be natural patina of raw iron (unless specified otherwise; see below).

Finish:

- Raw (standard)
 - Rust conditioner
 - Polyester Powder Coat*
 - Liquid Coat (wet paint)*
- Color:
- *Please specify standard UA color or mfr. name and color code.
 - Brush (bronze/nickel/aluminum only)
 - Polish (bronze/nickel/aluminum only)
 - Galvanized (grey iron and ductile iron only)
 - Other:

- Dimensions are nominal.

Notes

- 1) Cast in four pieces.
- 2) Grate is 1 1/4" thick at edge.
- 3) Center opening expansion at 24 1/2" and 33".
- 4) No openings greater than 1/2", in conformance with ADA Accessibility Guidelines.

Comments:

Tree Grate

5' Sq. Variations
Configuration Parallel

Page 3 of 5 Date: 3/31/14



465 E. FIFTEENTH ST. sales@urbanaccessories.com
TACOMA, WA 98421 www.urbanaccessories.com
(877) 487-0488

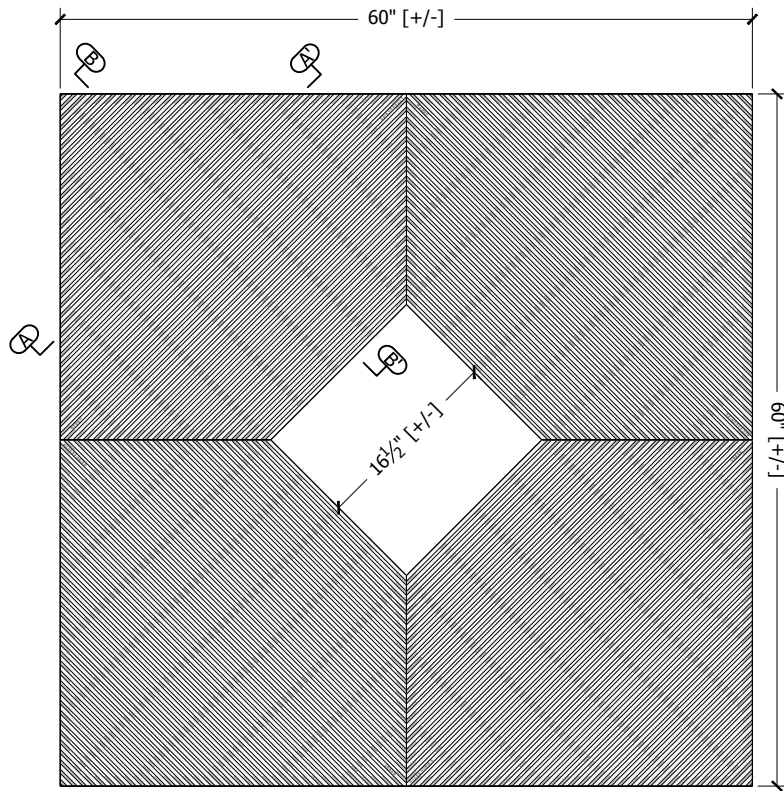

Plan

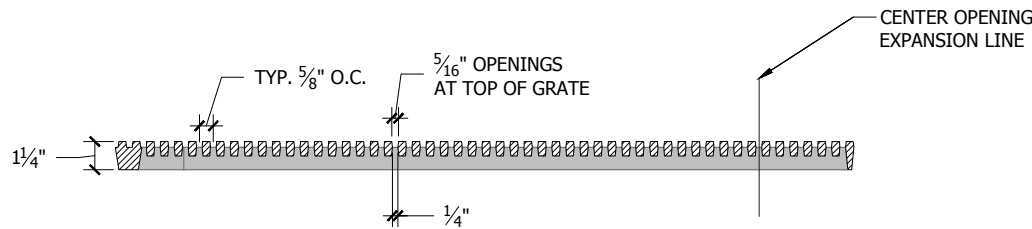

Section B-B'

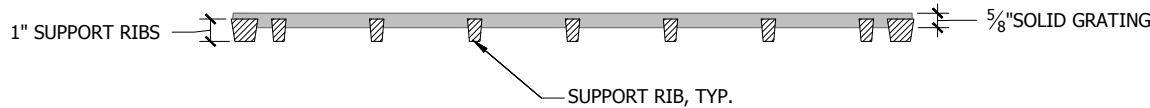

Section A-A'

SPECIFICATIONS

- Material will be high quality 100% recycled grey iron; ASTM A48 class 35b or better; hardness 170-223 brinnell (unless specified otherwise; see below).

Material:

- Grey iron ASTM A48 (standard)
- Aluminum, ASTM B26
- Ductile iron, (required for all load ratings higher than pedestrian) ASTM A536 class 65-45-12.
- Nickel bronze (ASTM B30)
- Bronze (ASTM B26)

- Finish will be natural patina of raw iron (unless specified otherwise; see below).

Finish:

- Raw (standard)
 - Rust conditioner
 - Polyester Powder Coat*
 - Liquid Coat (wet paint)*
- Color:
- *Please specify standard UA color or mfr. name and color code.
 - Brush (bronze/nickel/aluminum only)
 - Polish (bronze/nickel/aluminum only)
 - Galvanized (grey iron and ductile iron only)
 - Other:

- **Dimensions are nominal.**

Notes

- 1) Cast in four pieces.
- 2) Grate is 1 1/4" thick at edge.
- 3) Center opening expansion at 24 1/2" and 33".
- 4) No openings greater than 1/2", in conformance with ADA Accessibility Guidelines.

Comments:

Tree Grate

5' Sq. Variations
Configuration Diamond

Page 4 of 5 Date: 3/31/14



465 E. FIFTEENTH ST. sales@urbanaccessories.com
TACOMA, WA 98421 www.urbanaccessories.com
(877) 487-0488

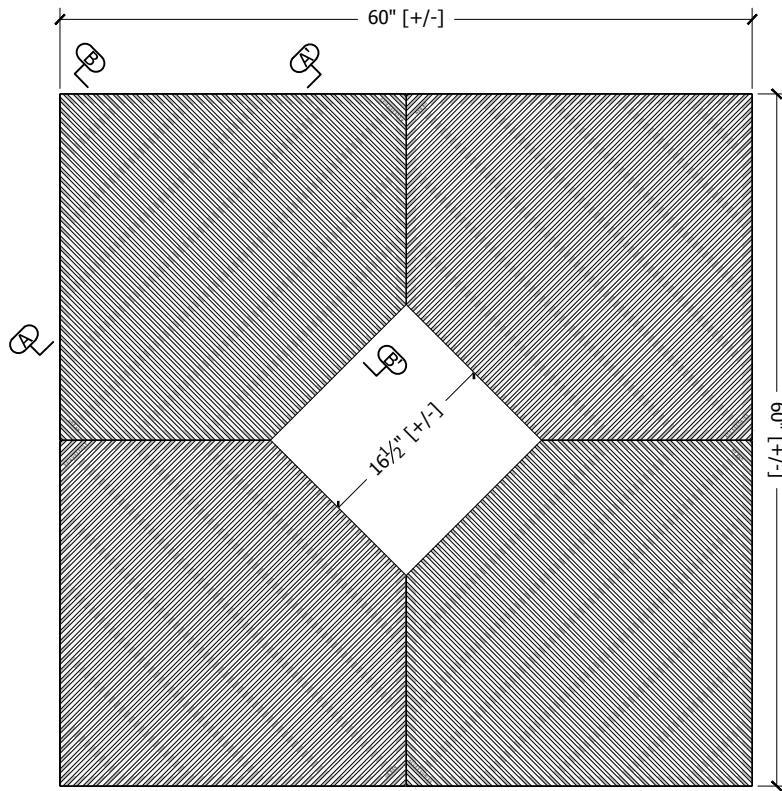

Plan

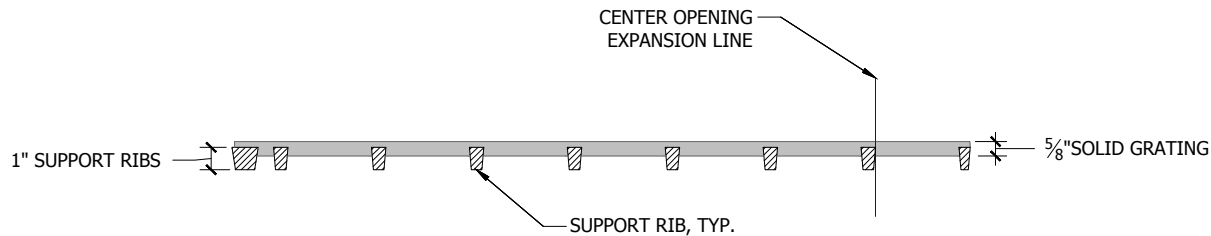

Section B-B'

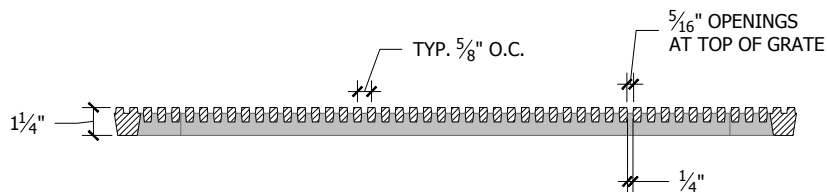

Section A-A'

SPECIFICATIONS

- Material will be high quality 100% recycled grey iron; ASTM A48 class 35b or better; hardness 170-223 brinnell (unless specified otherwise; see below).

Material:

- Grey iron ASTM A48 (standard)
- Aluminum, ASTM B26
- Ductile iron, (required for all load ratings higher than pedestrian) ASTM A536 class 65-45-12.
- Nickel bronze (ASTM B30)
- Bronze (ASTM B26)

- Finish will be natural patina of raw iron (unless specified otherwise; see below).

Finish:

- Raw (standard)
- Rust conditioner
- Polyester Powder Coat*
- Liquid Coat (wet paint)*
- Color:
 - *Please specify standard UA color or mfr. name and color code.
 - Brush (bronze/nickel/aluminum only)
 - Polish (bronze/nickel/aluminum only)
 - Galvanized (grey iron and ductile iron only)
 - Other:

- Dimensions are nominal.

Notes

- 1) Cast in four pieces.
- 2) Grate is 1 1/4" thick at edge.
- 3) Center opening expansion at 24 1/2" and 33".
- 4) No openings greater than 1/2", in conformance with ADA Accessibility Guidelines.

Comments:

Tree Grate

**5' Sq. Variations
Configuration X**

Page 5 of 5 Date: 3/31/14



465 E. FIFTEENTH ST. sales@urbanaccessories.com
TACOMA, WA 98421 www.urbanaccessories.com
(877) 487-0488