

SPECS - TYPE S

- Type S frames are for permanent installs into new concrete w/o pavers (for permanent frames with pavers use Type P)
- Rebar anchoring is **NOT** pre-bent, bending to be done by installer prior to installation into concrete
- Nelson studs may be specified in lieu of rebar (additional specs will be required)
- For load ratings greater than pedestrian modifications to the frame may need to be made, for more information contact your rep or UA.

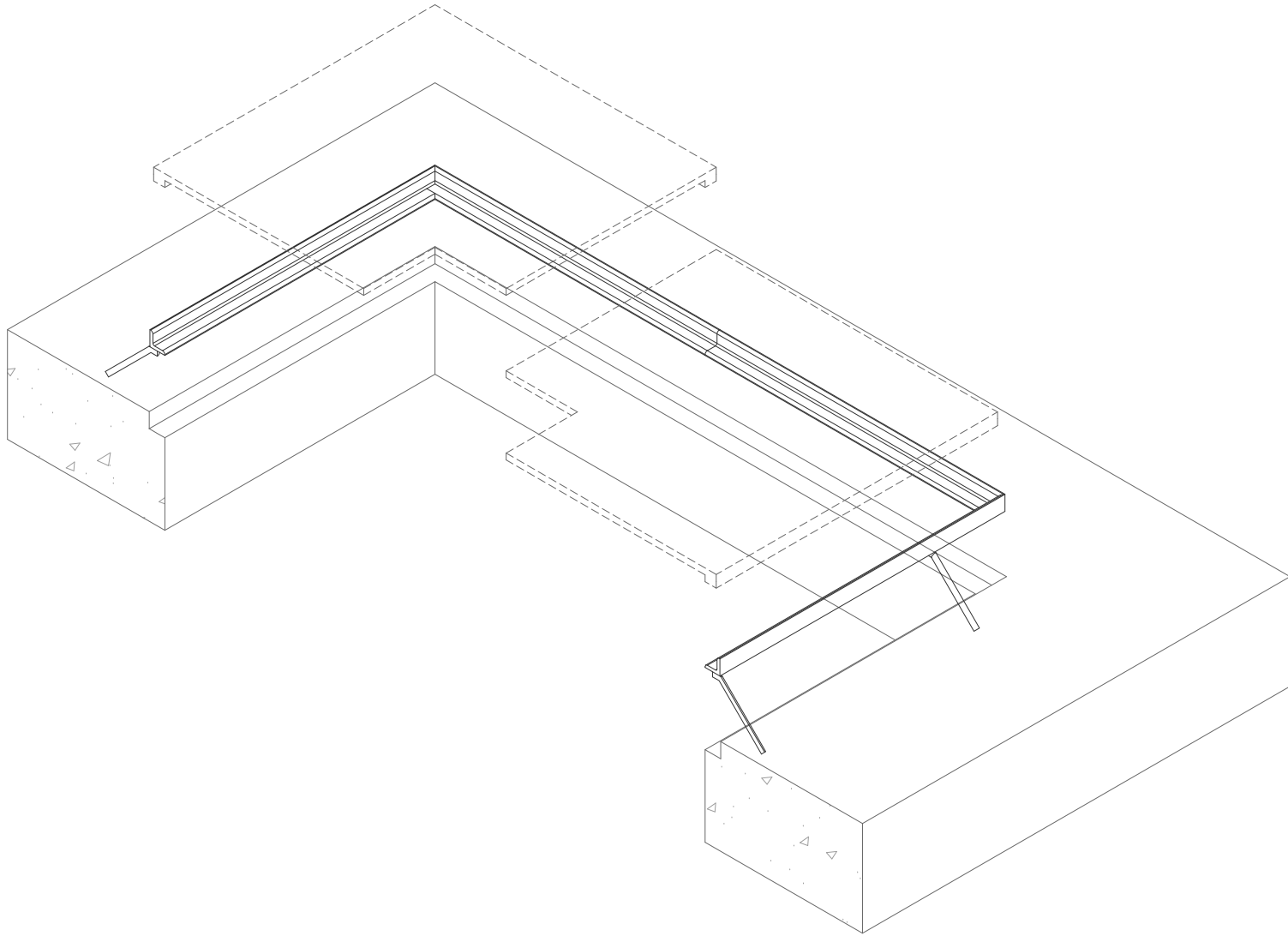

Type S - Exploded Assembly  
Scale: 1" = 1' 0"

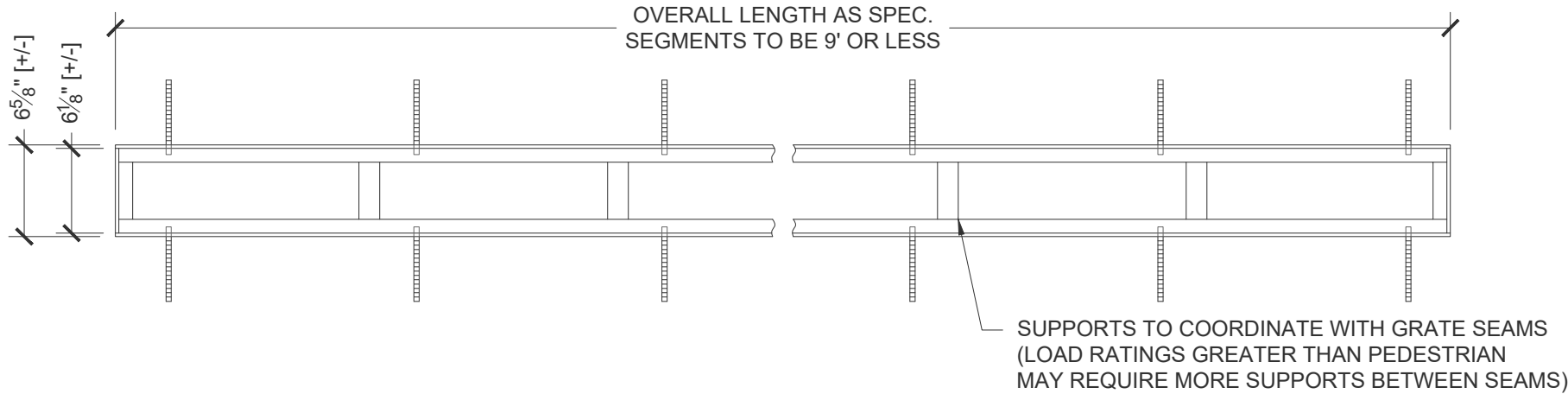

Example 6' Trench Frame - Plan  
Scale: 1" = 1' 0"

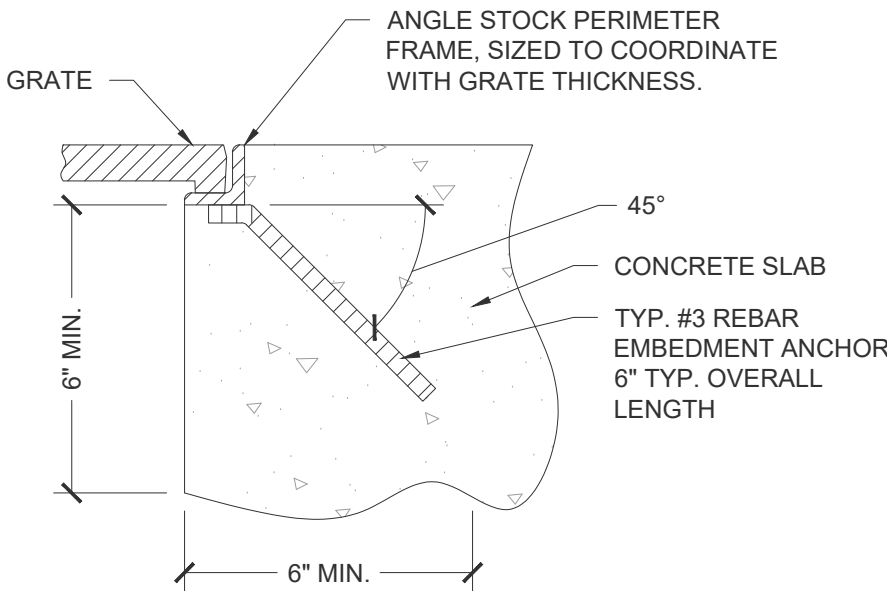

Type S - Section  
Scale: 3" = 1' 0"

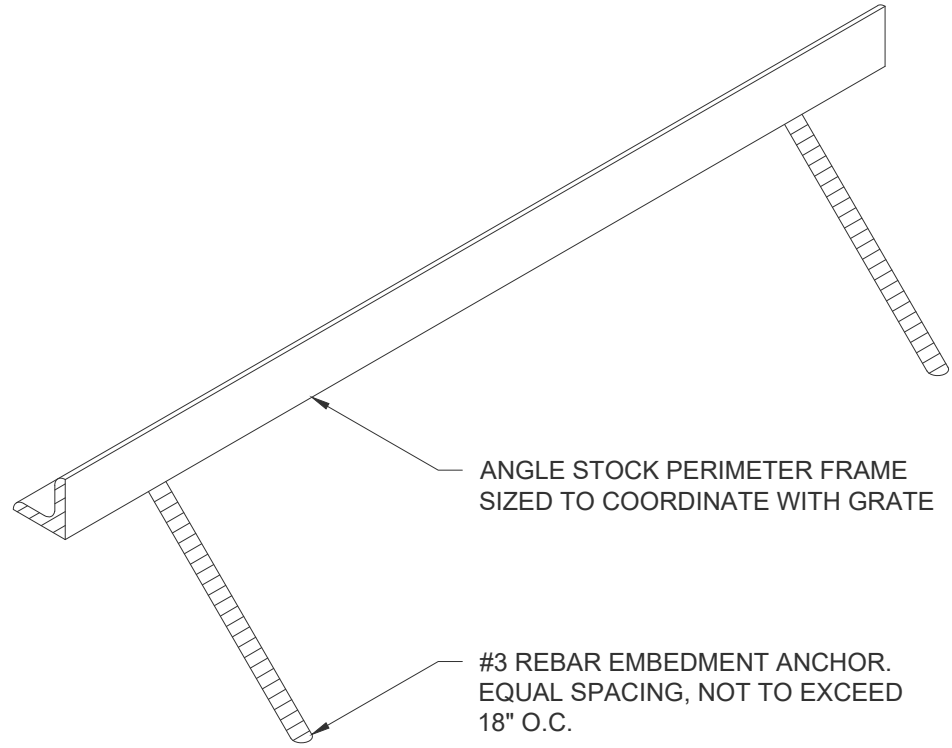

Type S - Isometric  
Scale: 3" = 1' 0"

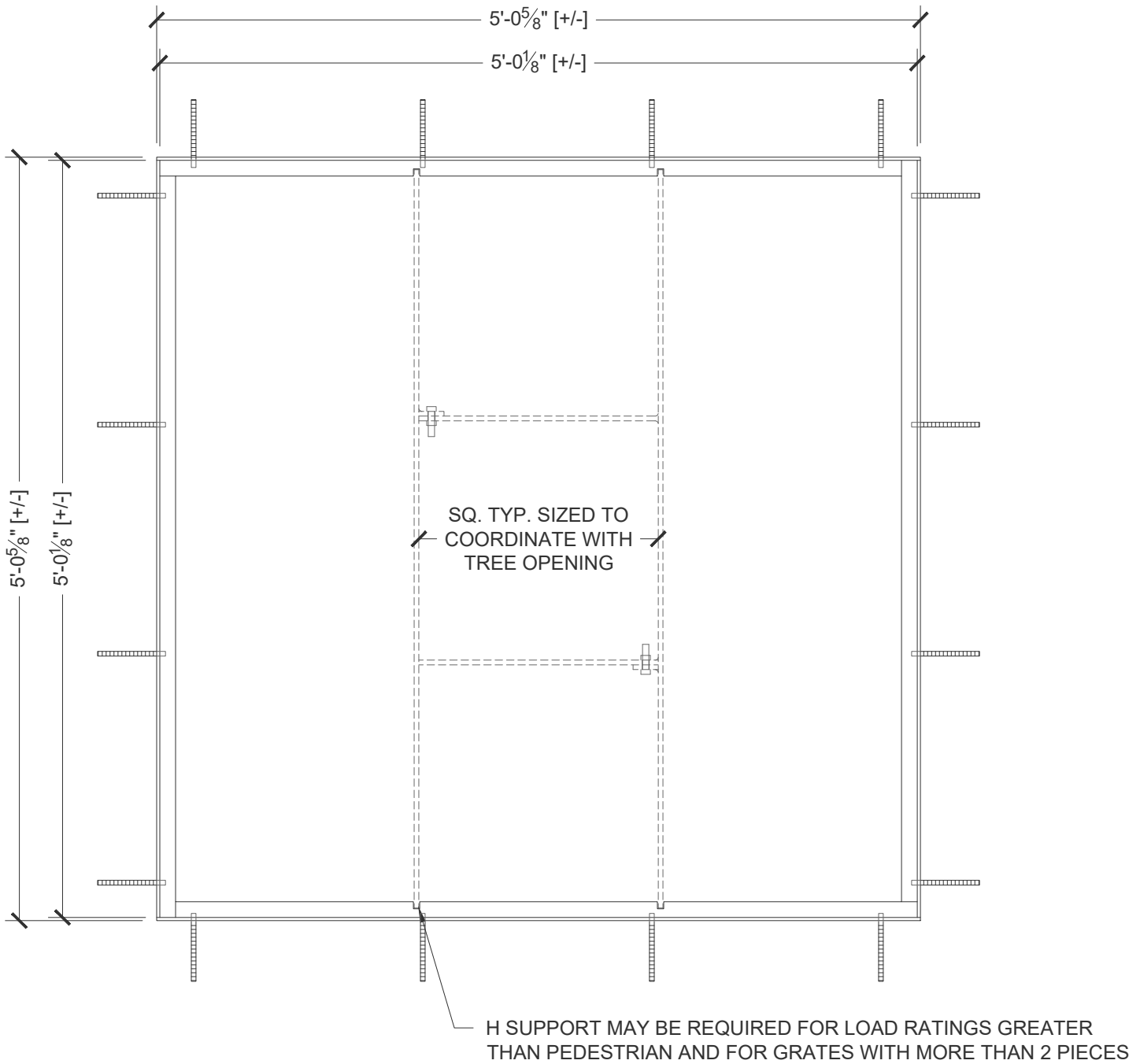

Example 5' Tree Grate Frame - Plan  
Scale: 1" = 1' 0"

URBAN ACCESSORIES

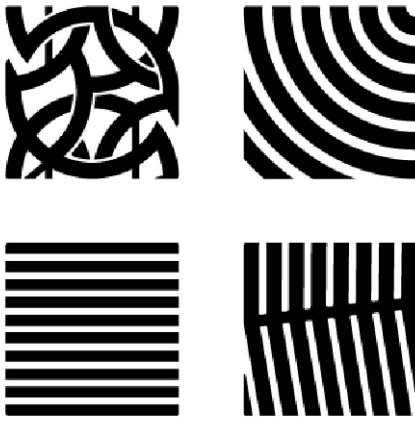

465 E 15th Street, Tacoma, WA 98421  
1.877.487.0488 | 1.253.572.1112

This print is the property of Urban Accessories, Inc. and is loaned to the recipient subject to be returned on demand. All contents herein are confidential and must not be copied or submitted to outside parties for examination without the express written consent of Urban Accessories, Inc.

If you received these documents in mistake please contact  
sales@urbanaccessories.com.

Project Name	Blank
Specified By	Blank
Sales Contact	sales@urbanaccessories.com
Project Location	Tacoma, WA
Page #	1 of 6

Additional Notes

GENERIC FRAME DETAILS

Typical for all frames

STANDARD SPECIFICATIONS

- Material will be high quality ASTM A36 mild steel (unless specified otherwise).
- Default finish will be natural patina of raw material (unless specified otherwise).
- Frames are load rated for pedestrian traffic only (Other load ratings available at request).
- Gap of <sup>1</sup>/<sub>8</sub>" is typical between grate and interior frame edge. All visible edges are ground smooth on outside edges and are true to square or round. Top of grate to be flush with grade.
- Dimensions are nominal (sized to fit grates).

OPTIONS

Options listed below are available for all frames. Some options may not be available with certain load ratings or materials.

- Materials:**  
Stainless Steel, 304L  
Aluminum, 6061 T6  
Architectural Bronze
- Finishes:**  
Polyester Powder Coat  
Liquid coat (Specify color)  
Brush  
Polish  
Galvanized  
Other: \_\_\_\_\_ (With approval from UA)
- Load Ratings:**  
Light Vehicular (Medium Duty)  
H20/HS20 (Heavy Duty)

ADDITIONAL NOTES

- For specific details please contact your local rep or UA.
- PDFs and DWGs are available for all sizes of frames from your sales representative or by emailing sales@urbanaccessories.com

DRAWING INFO

Drawn By	NR
Date Drawn	3.19.2020

SPECS - TYPE PA

- Type PA frames are for non-permanent top mount installs into existing concrete w/ pavers (for permanent frames with pavers use Type P)
- Anchors are **NOT** provided by UA, anchors to be provided by installer prior to installation into concrete
- Tab sizes and overall height can be customized (additional specs will be required)
- For load ratings greater than pedestrian modifications to the frame may need to be made, for more information contact your rep or UA.

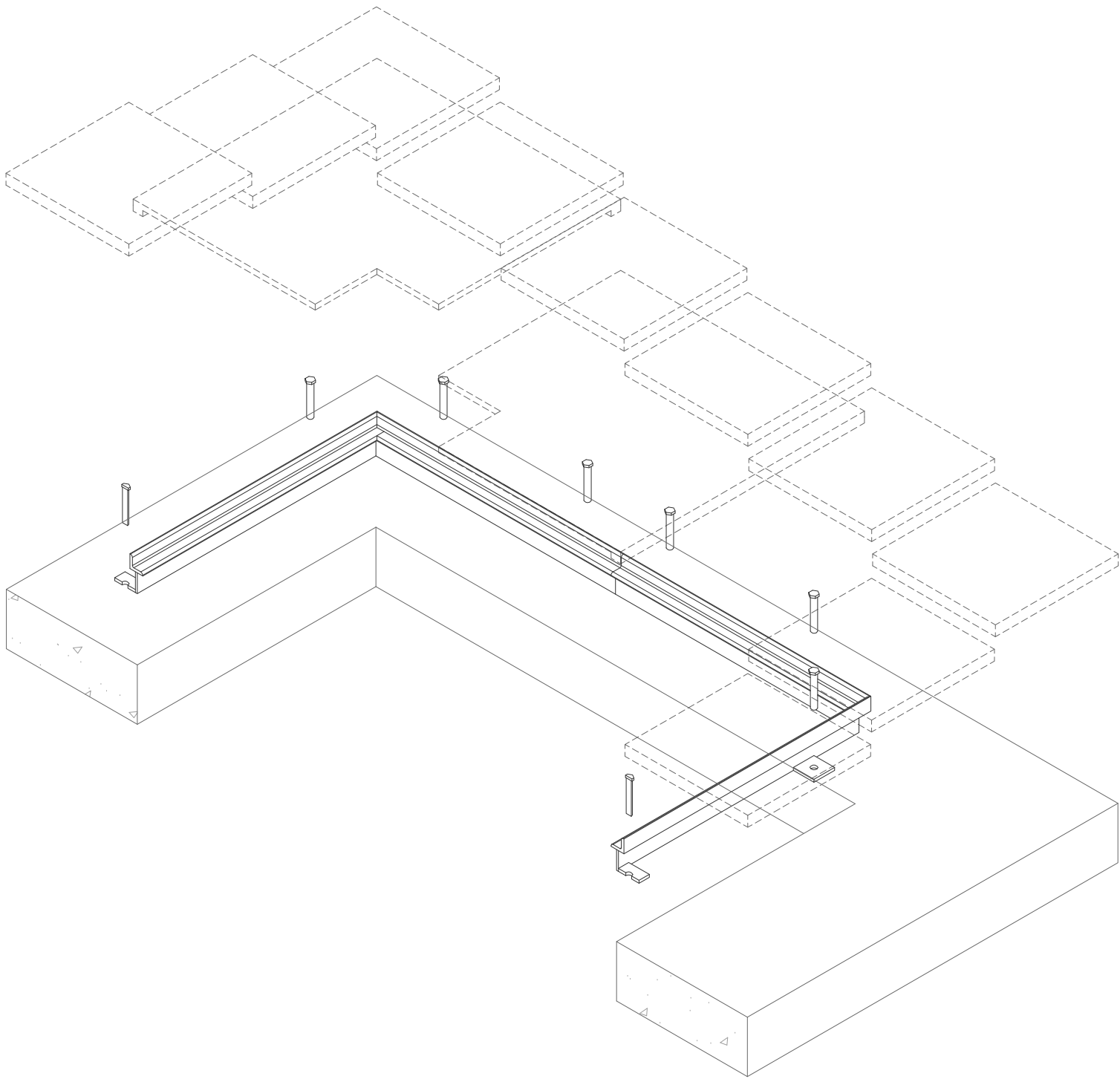

Type PA - Exploded Assembly  
Scale: 1" = 1' 0"

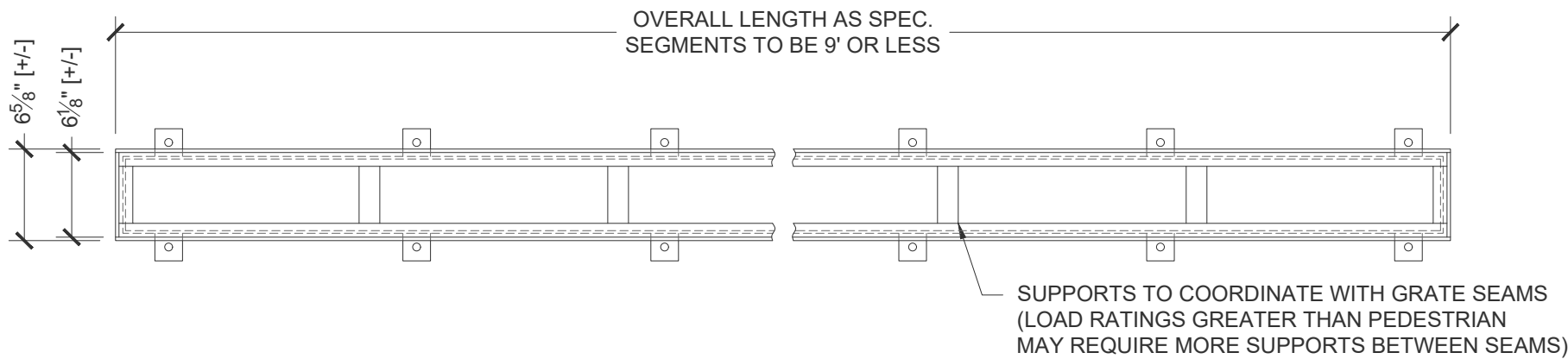

Example 6" Trench Frame - Plan  
Scale: 1" = 1' 0"

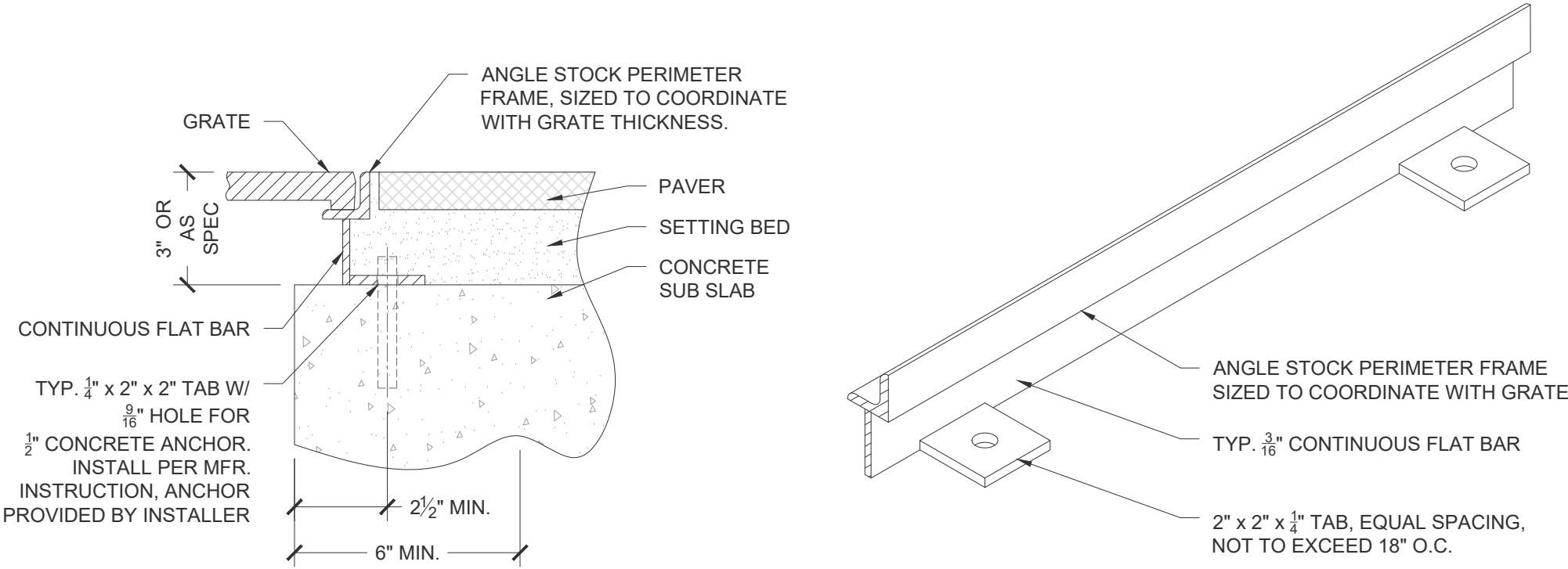

Type PA - Section  
Scale: 3" = 1' 0"

Type PA - Isometric  
Scale: 3" = 1' 0"

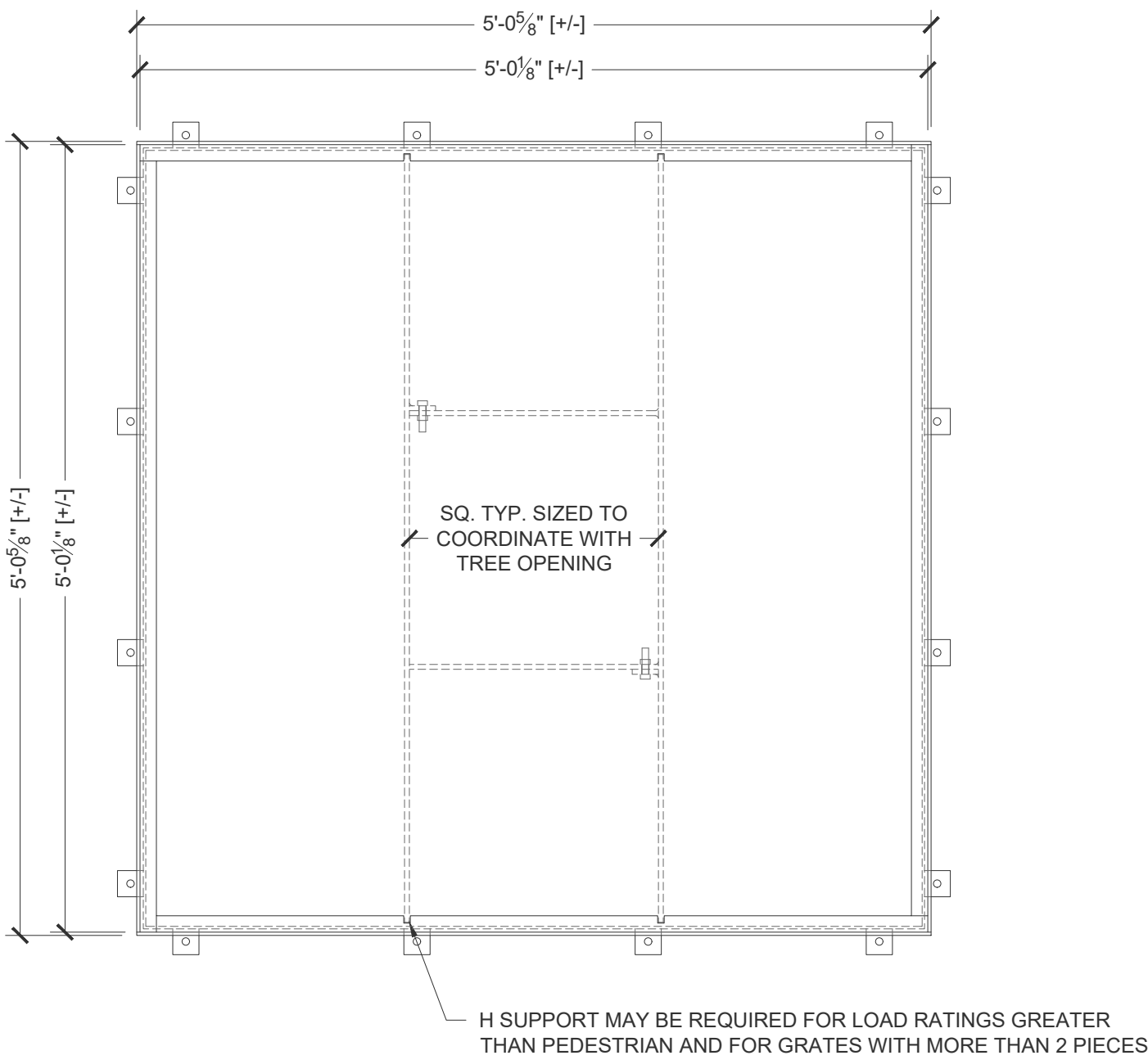

Example 5' Tree Grate Frame - Plan  
Scale: 1" = 1' 0"

URBAN ACCESSORIES

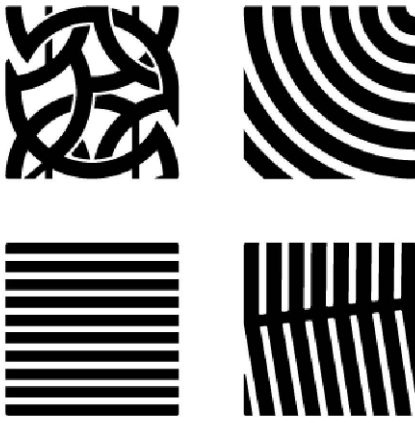

465 E 15th Street, Tacoma, WA 98421  
1.877.487.0488 | 1.253.572.1112

This print is the property of Urban Accessories, Inc. and is loaned to the recipient subject to be returned on demand. All contents herein are confidential and must not be copied or submitted to outside parties for examination without the express written consent of Urban Accessories, Inc.

If you received these documents in mistake please contact  
sales@urbanaccessories.com.

Project Name	Blank
Specified By	Blank
Sales Contact	sales@urbanaccessories.com
Project Location	Tacoma, WA
Page #	2 of 6

Additional Notes

GENERIC FRAME DETAILS

Typical for all frames

STANDARD SPECIFICATIONS

- Material will be high quality ASTM A36 mild steel (unless specified otherwise).
- Default finish will be natural patina of raw material (unless specified otherwise).
- Frames are load rated for pedestrian traffic only (Other load ratings available at request).
- Gap of  $\frac{1}{8}$ " is typical between grate and interior frame edge. All visible edges are ground smooth on outside edges and are true to square or round. Top of grate to be flush with grade.
- Dimensions are nominal (sized to fit grates).

OPTIONS

Options listed below are available for all frames. Some options may not be available with certain load ratings or materials.

**Materials:**  
Stainless Steel, 304L  
Aluminum, 6061 T6  
Architectural Bronze

**Finishes:**  
Polyester Powder Coat  
Liquid coat (Specify color)  
Brush  
Polish  
Galvanized  
Other: \_\_\_\_\_ (With approval from UA)

**Load Ratings:**  
Light Vehicular (Medium Duty)  
H20/HS20 (Heavy Duty)

ADDITIONAL NOTES

- For specific details please contact your local rep or UA.
- PDFs and DWGs are available for all sizes of frames from your sales representative or by emailing sales@urbanaccessories.com

DRAWING INFO

Drawn By	NR
Date Drawn	3.19.2020

SPECS - TYPE P

- Type P frames are for permanent installs into new concrete w/ pavers (for permanent frames without pavers use Type S)
- Rebar anchoring is **NOT** pre-bent, bending to be done by installer prior to installation into concrete
- Nelson studs may be specified in lieu of rebar (additional specs will be required)
- Tab sizes and overall height can be customized (additional specs will be required)
- For load ratings greater than pedestrian modifications to the frame may need to be made, for more information contact your rep or UA.

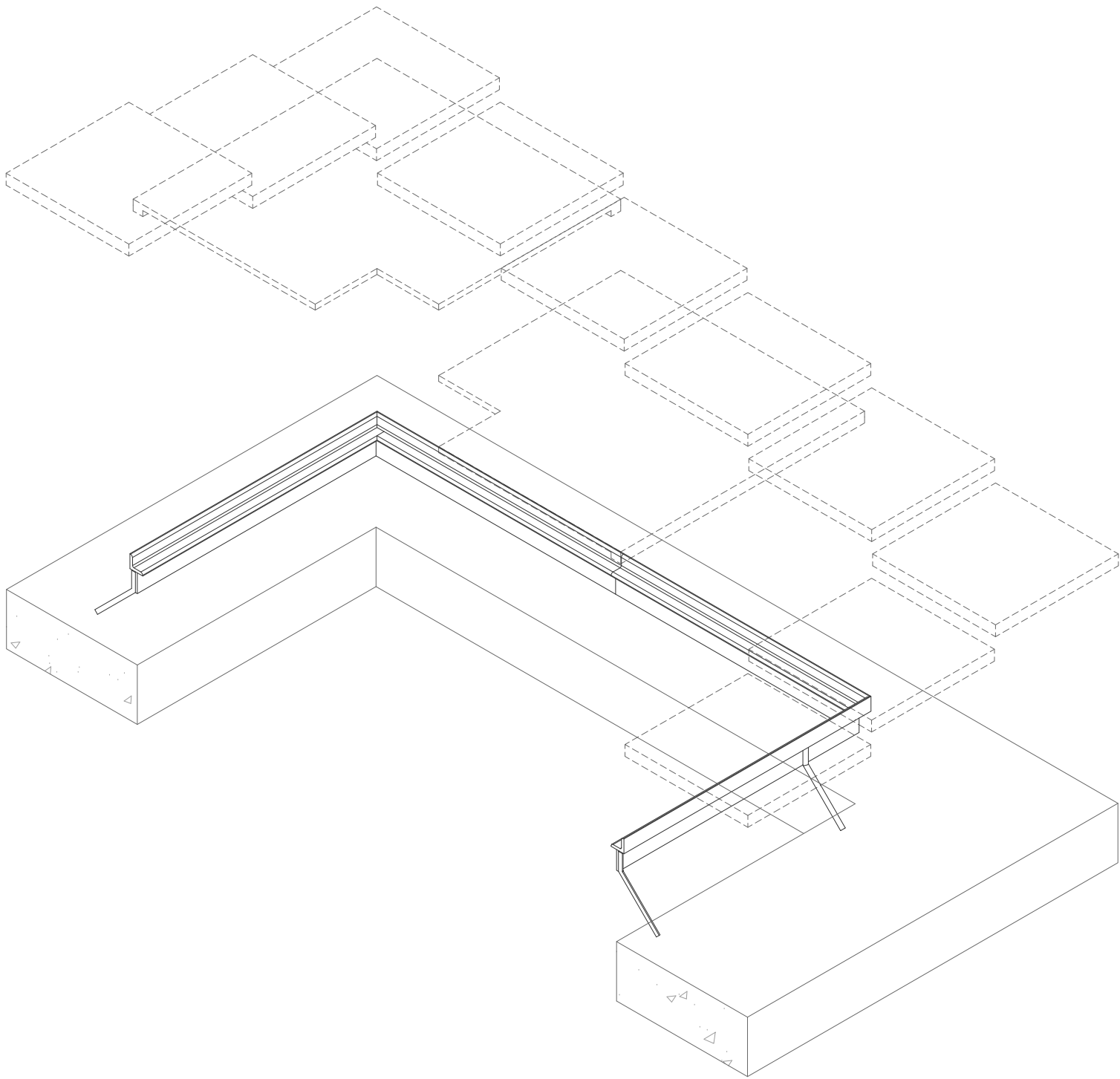

Type P - Exploded Assembly  
Scale: 1" = 1' 0"

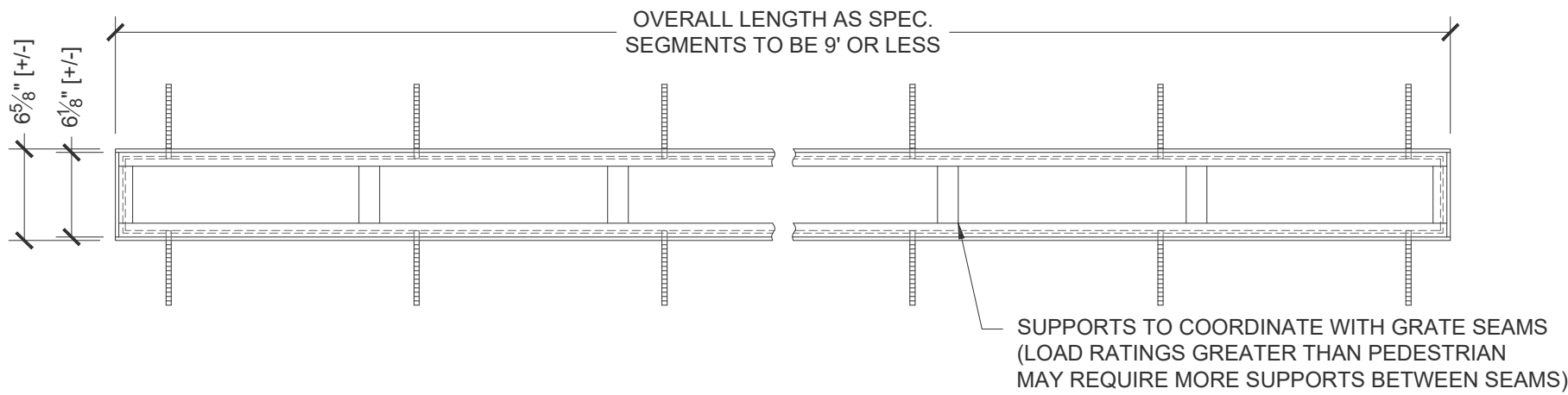

Example 6" Trench Frame - Plan  
Scale: 1" = 1' 0"

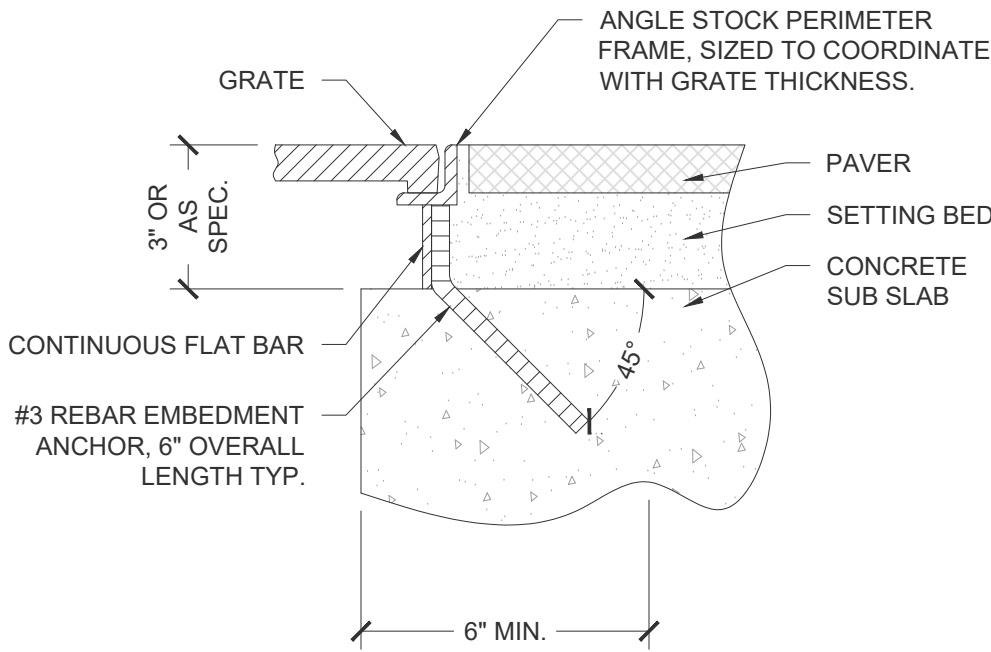

Type P - Section  
Scale: 3" = 1' 0"

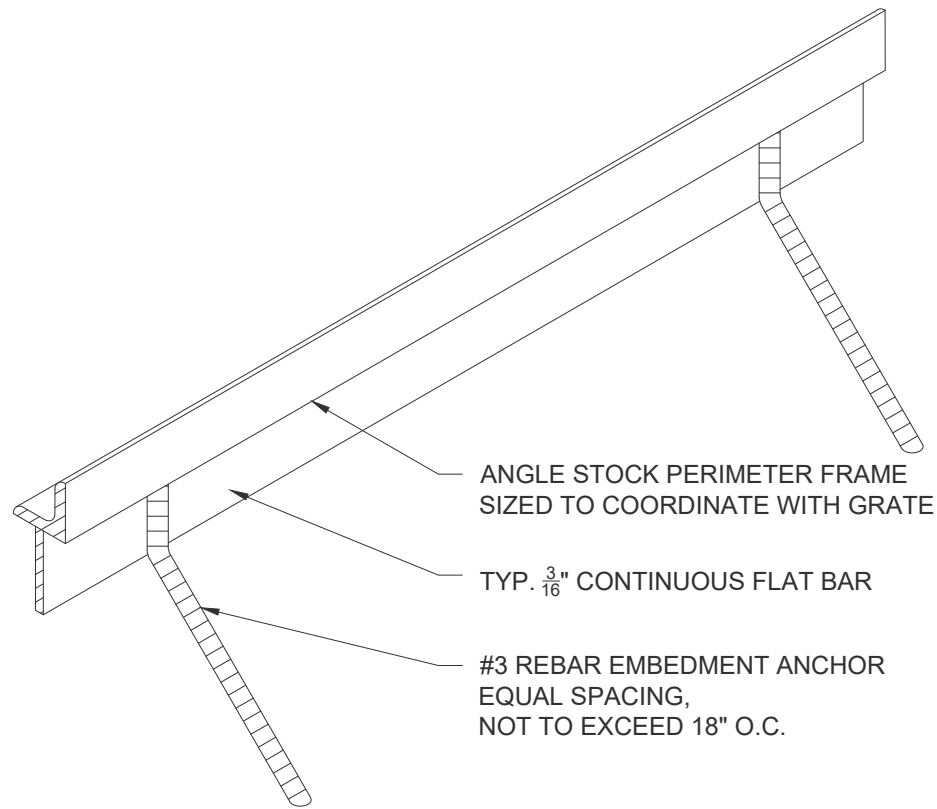

Type P - Isometric  
Scale: 3" = 1' 0"

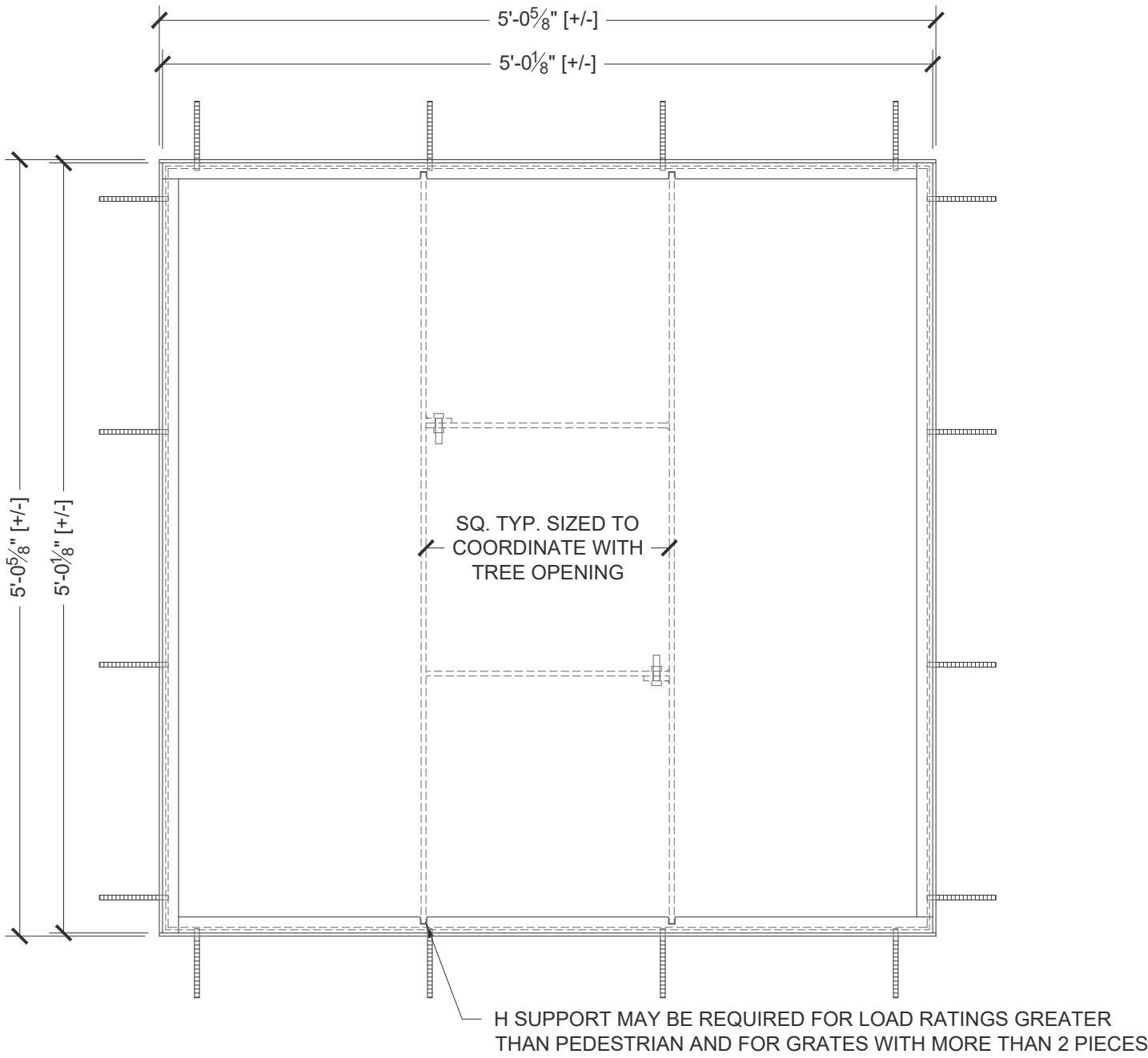

Example 5' Tree Grate Frame - Plan  
Scale: 1" = 1' 0"

URBAN ACCESSORIES



465 E 15th Street, Tacoma, WA 98421  
1.877.487.0488 | 1.253.572.1112

This print is the property of Urban Accessories, Inc. and is loaned to the recipient subject to be returned on demand. All contents herein are confidential and must not be copied or submitted to outside parties for examination without the express written consent of Urban Accessories, Inc.

If you received these documents in mistake please contact  
sales@urbanaccessories.com.

Project Name	Blank
Specified By	Blank
Sales Contact	sales@urbanaccessories.com
Project Location	Tacoma, WA
Page #	3 of 6

Additional Notes

GENERIC FRAME DETAILS

Typical for all frames

STANDARD SPECIFICATIONS

- Material will be high quality ASTM A36 mild steel (unless specified otherwise).
- Default finish will be natural patina of raw material (unless specified otherwise).
- Frames are load rated for pedestrian traffic only (Other load ratings available at request).
- Gap of 1/8" is typical between grate and interior frame edge. All visible edges are ground smooth on outside edges and are true to square or round. Top of grate to be flush with grade.
- Dimensions are nominal (sized to fit grates).

OPTIONS

Options listed below are available for all frames. Some options may not be available with certain load ratings or materials.

- Materials:**  
Stainless Steel, 304L  
Aluminum, 6061 T6  
Architectural Bronze
- Finishes:**  
Polyester Powder Coat  
Liquid coat (Specify color)  
Brush  
Polish  
Galvanized  
Other: \_\_\_\_\_ (With approval from UA)
- Load Ratings:**  
Light Vehicular (Medium Duty)  
H20/HS20 (Heavy Duty)

ADDITIONAL NOTES

- For specific details please contact your local rep or UA.
- PDFs and DWGs are available for all sizes of frames from your sales representative or by emailing sales@urbanaccessories.com

DRAWING INFO

Drawn By	NR
Date Drawn	3.19.2020

SPECS - TYPE R

- Type R frames are for non-permanent side mount installs into existing concrete w/o pavers (for non-permanent frames with pavers use Type PA)
- Anchors are **NOT** provided by UA, anchors to be provided by installer prior to installation into concrete
- Tab sizes and overall height can be customized (additional specs will be required)
- For load ratings greater than pedestrian modifications to the frame may need to be made, for more information contact your rep or UA.

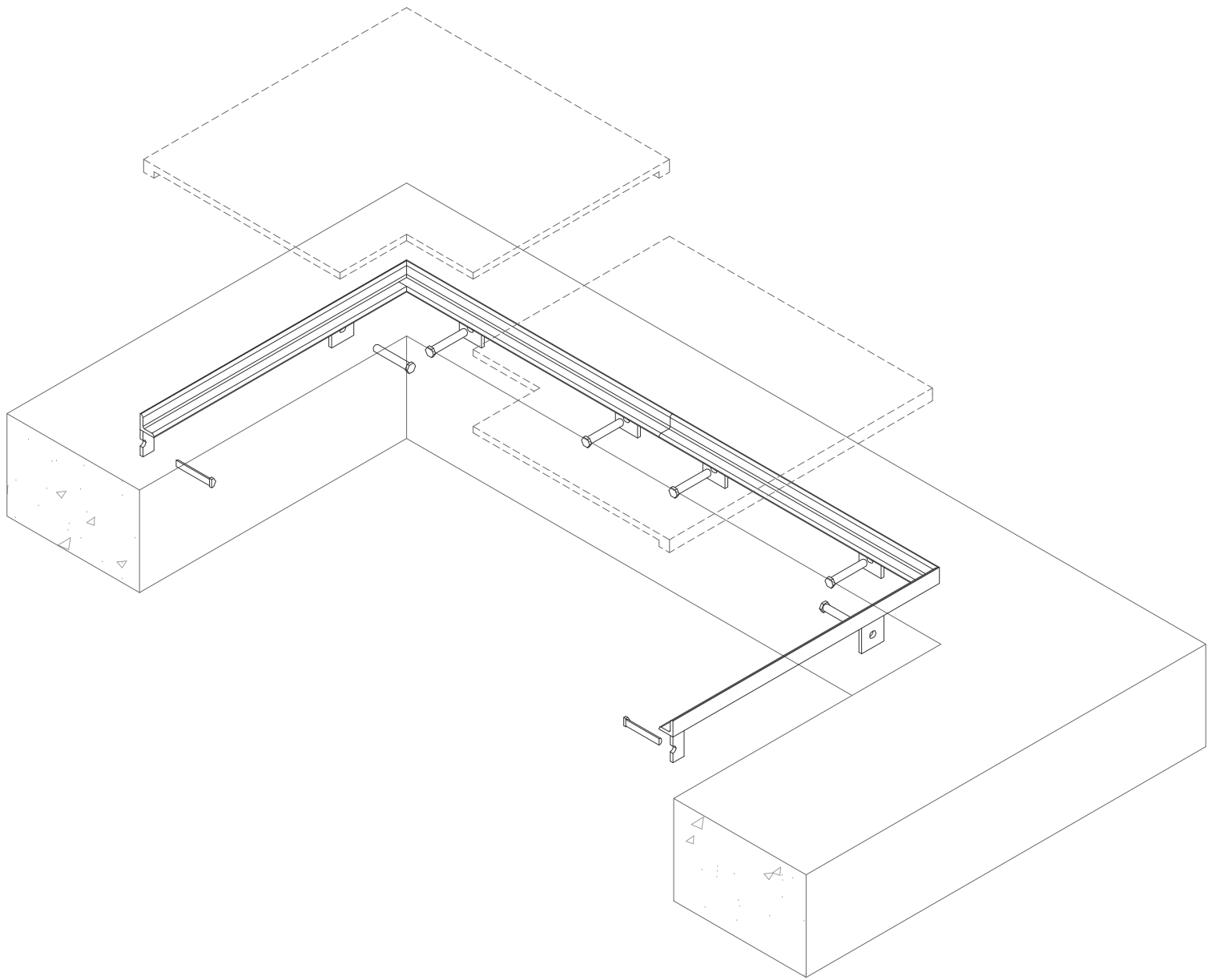

Type R - Exploded Assembly  
Scale: 1" = 1' 0"

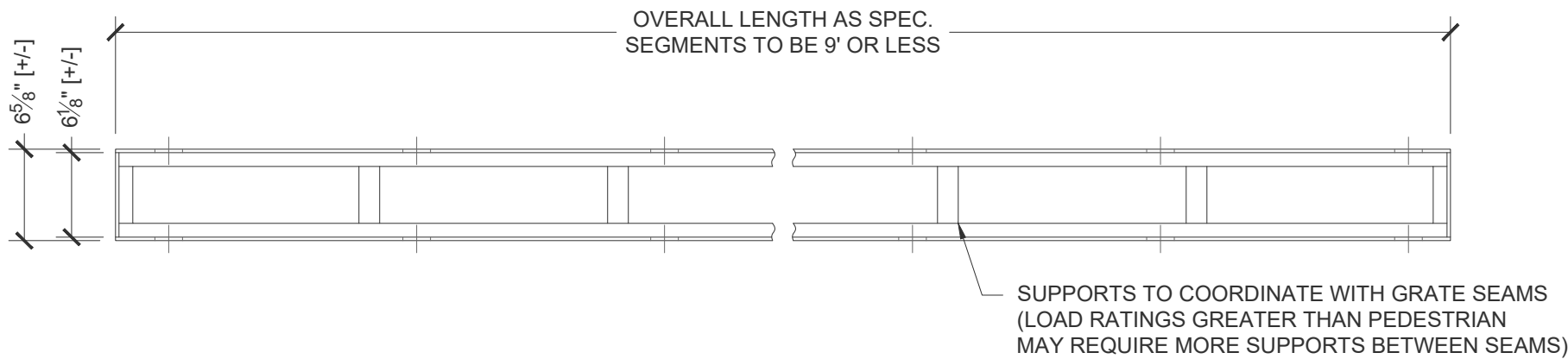

Example 6" Trench Frame - Plan  
Scale: 1" = 1' 0"

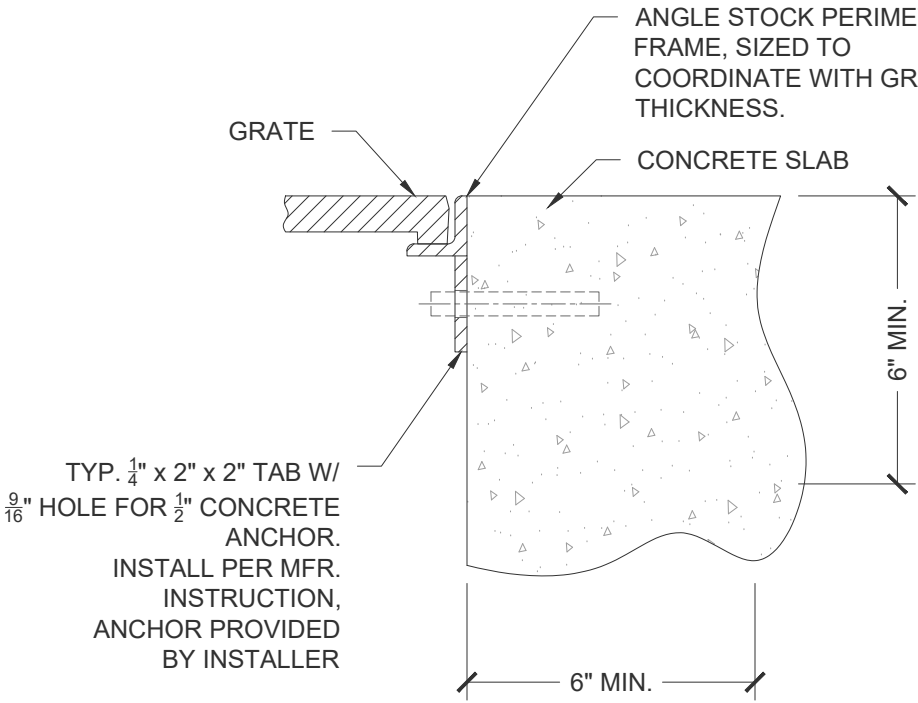

Type R - Section  
Scale: 3" = 1' 0"

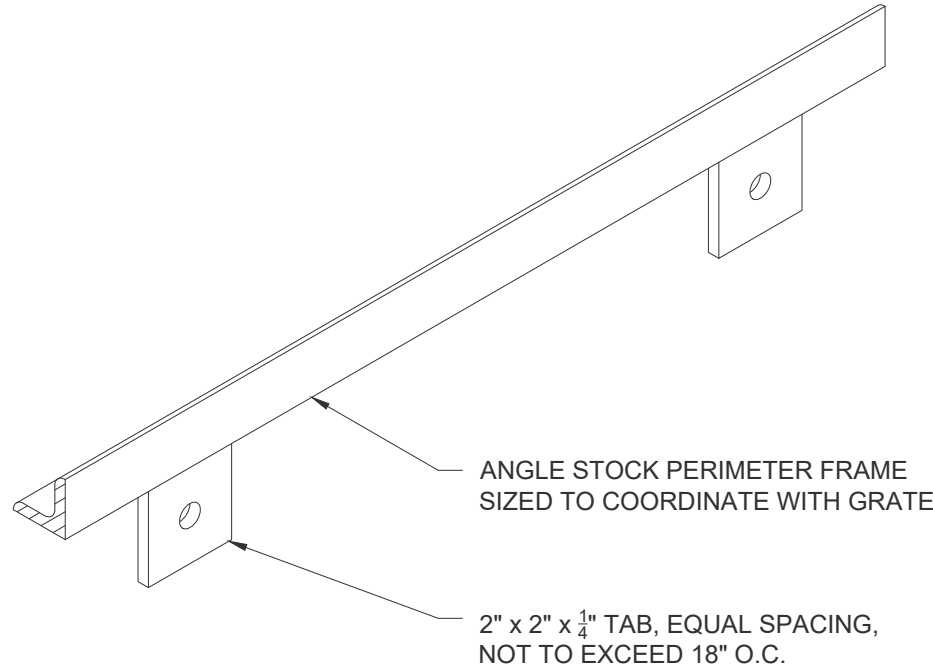

Type R - Isometric  
Scale: 3" = 1' 0"

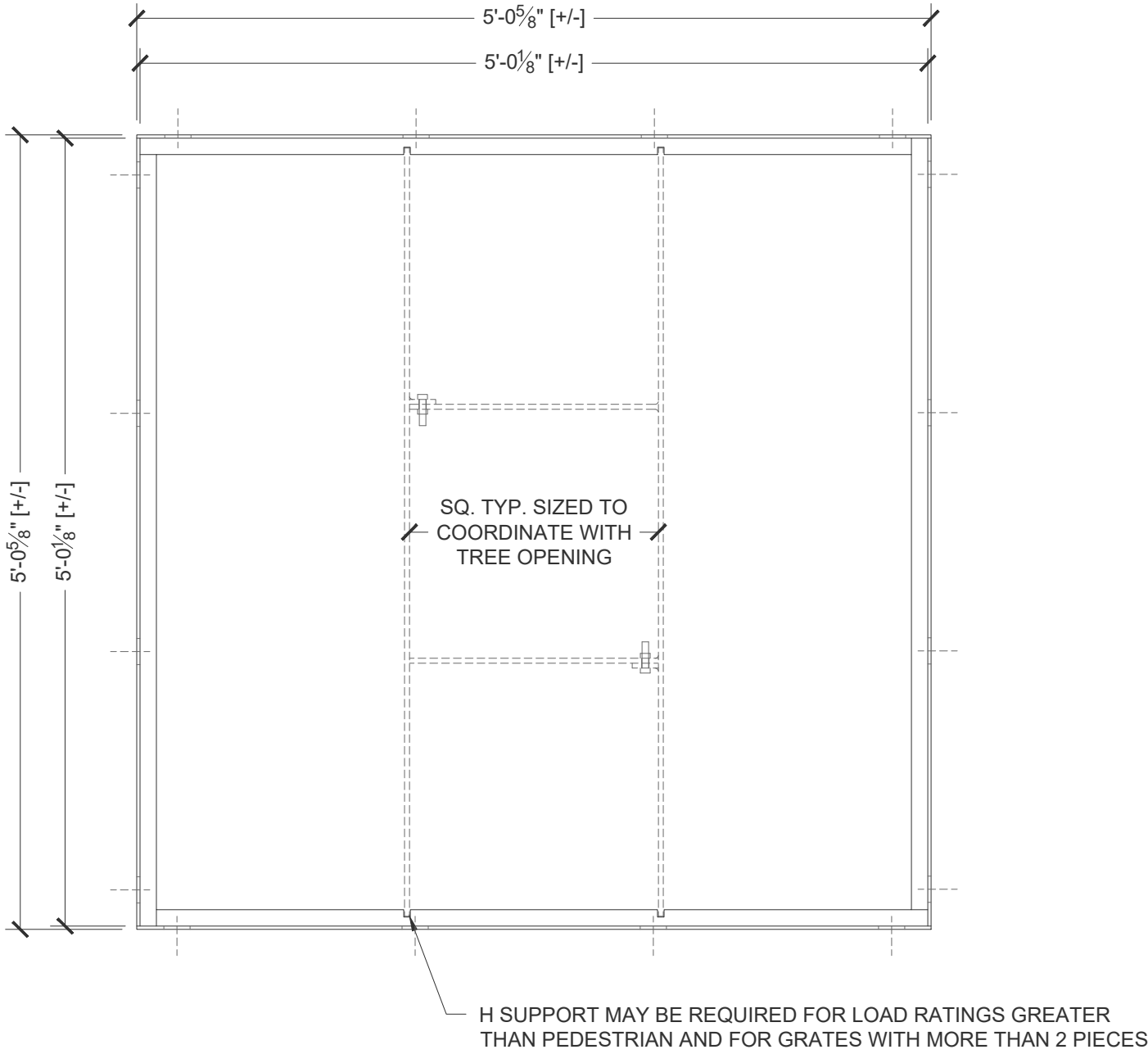

Example 5' Tree Grate Frame - Plan  
Scale: 1" = 1' 0"

URBAN ACCESSORIES

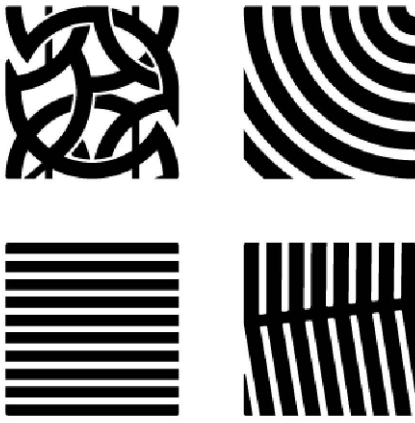

465 E 15th Street, Tacoma, WA 98421  
1.877.487.0488 | 1.253.572.1112

This print is the property of Urban Accessories, Inc. and is loaned to the recipient subject to be returned on demand. All contents herein are confidential and must not be copied or submitted to outside parties for examination without the express written consent of Urban Accessories, Inc.

If you received these documents in mistake please contact  
sales@urbanaccessories.com.

Project Name	Blank
Specified By	Blank
Sales Contact	sales@urbanaccessories.com
Project Location	Tacoma, WA
Page #	4 of 6

Additional Notes

GENERIC FRAME DETAILS

Typical for all frames

STANDARD SPECIFICATIONS

- Material will be high quality ASTM A36 mild steel (unless specified otherwise).
- Default finish will be natural patina of raw material (unless specified otherwise).
- Frames are load rated for pedestrian traffic only (Other load ratings available at request).
- Gap of 3/8" is typical between grate and interior frame edge. All visible edges are ground smooth on outside edges and are true to square or round. Tope of grate to be flush with grade.
- Dimensions are nominal (sized to fit grates).

OPTIONS

Options listed below are available for all frames. Some options may not be available with certain load ratings or materials.

- Materials:**  
Stainless Steel, 304L  
Aluminum, 6061 T6  
Architectural Bronze
- Finishes:**  
Polyester Powder Coat  
Liquid coat (Specify color)  
Brush  
Polish  
Galvanized  
Other: \_\_\_\_\_ (With approval from UA)
- Load Ratings:**  
Light Vehicular (Medium Duty)  
H20/HS20 (Heavy Duty)

ADDITIONAL NOTES

- For specific details please contact your local rep or UA.
- PDFs and DWGs are available for all sizes of frames from your sales representative or by emailing sales@urbanaccessories.com

DRAWING INFO

Drawn By	NR
Date Drawn	3.19.2020

SPECS - TYPE INVERTED R

- Type Inverted R frames are for non-permanent side mount installs into existing concrete when a steel border edge around the grate is not desired (for non-permanent frames with a steel border use Type R or S)
- Anchors are **NOT** provided by UA, anchors to be provided by installer prior to installation into concrete
- Tab sizes and overall height can be customized (additional specs will be required)
- For load ratings greater than pedestrian modifications to the frame may need to be made, for more information contact your rep or UA.

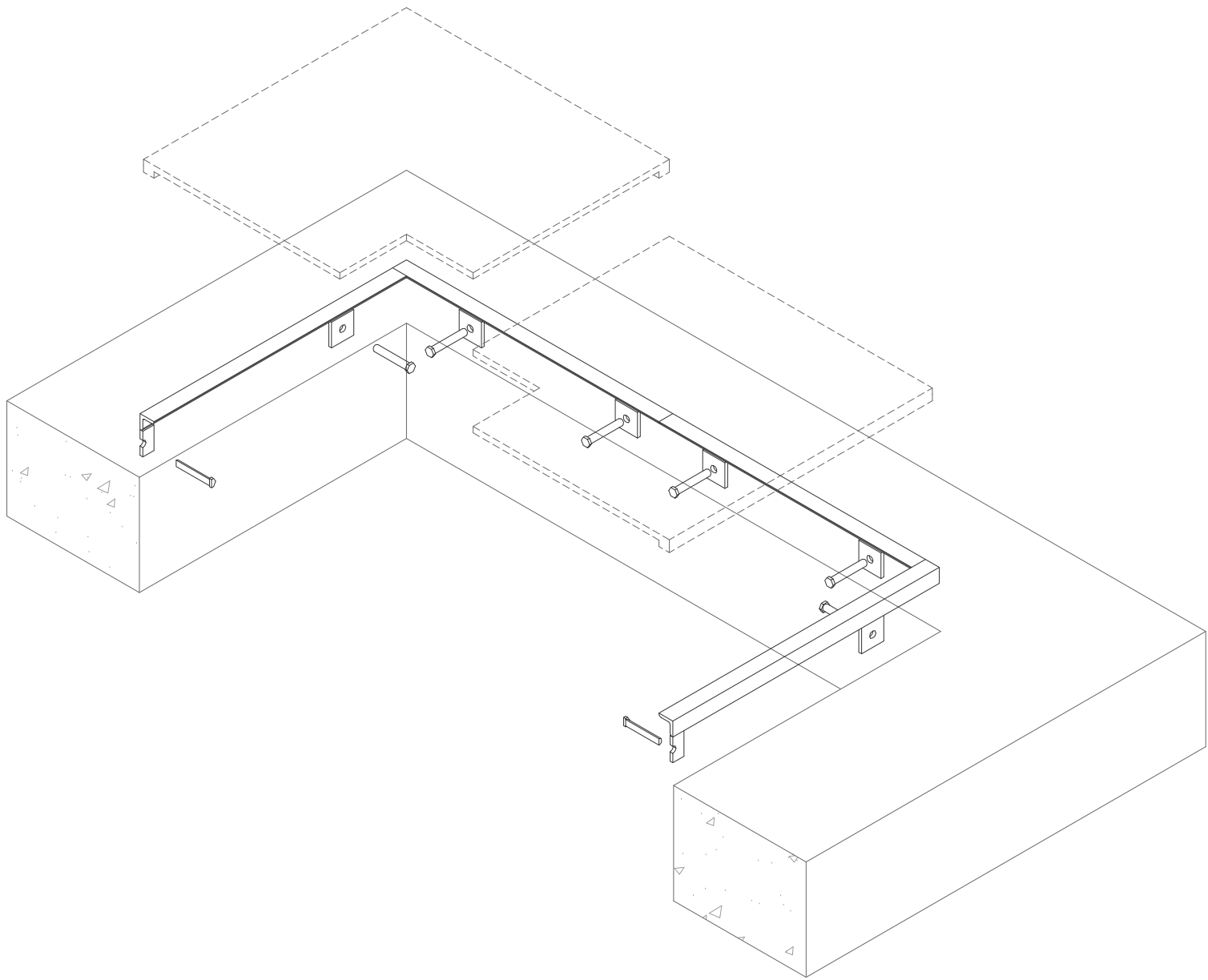

Type Inverted R - Exploded Assembly  
Scale: 1" = 1' 0"

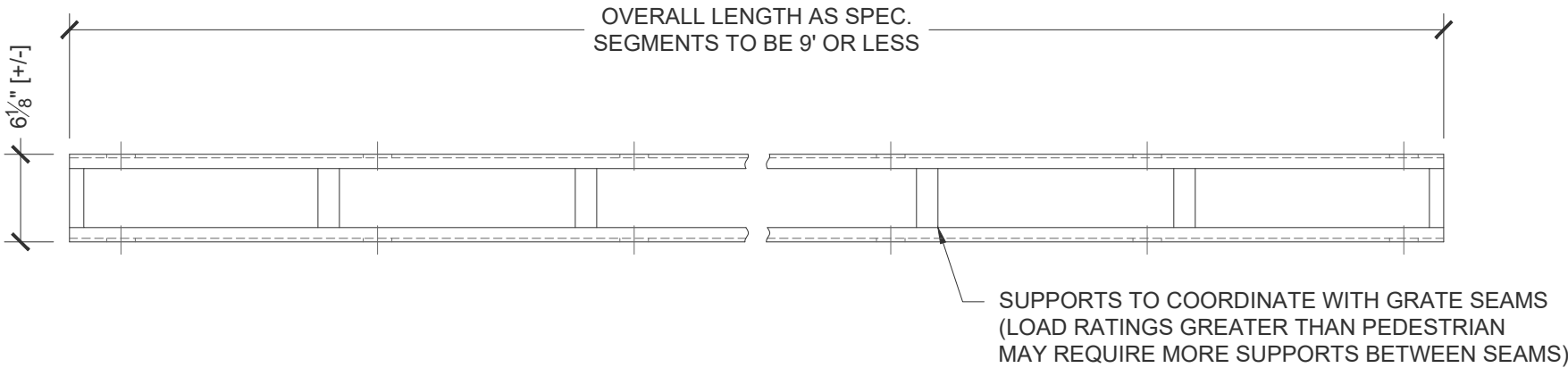

Example 6" Trench Frame - Plan  
Scale: 1" = 1' 0"

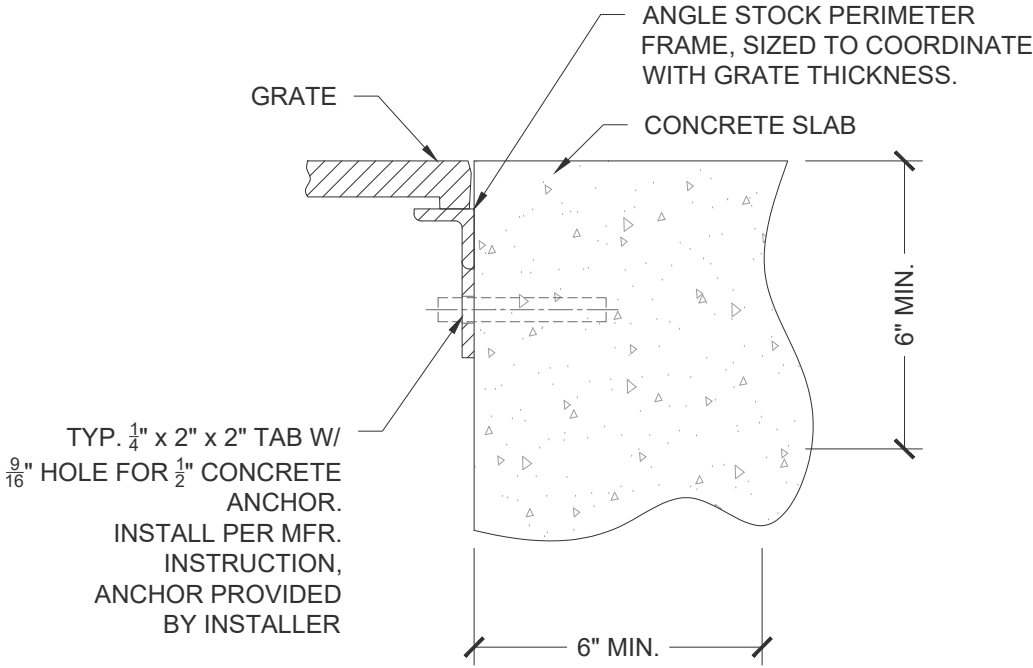

Type Inverted R - Section  
Scale: 3" = 1' 0"

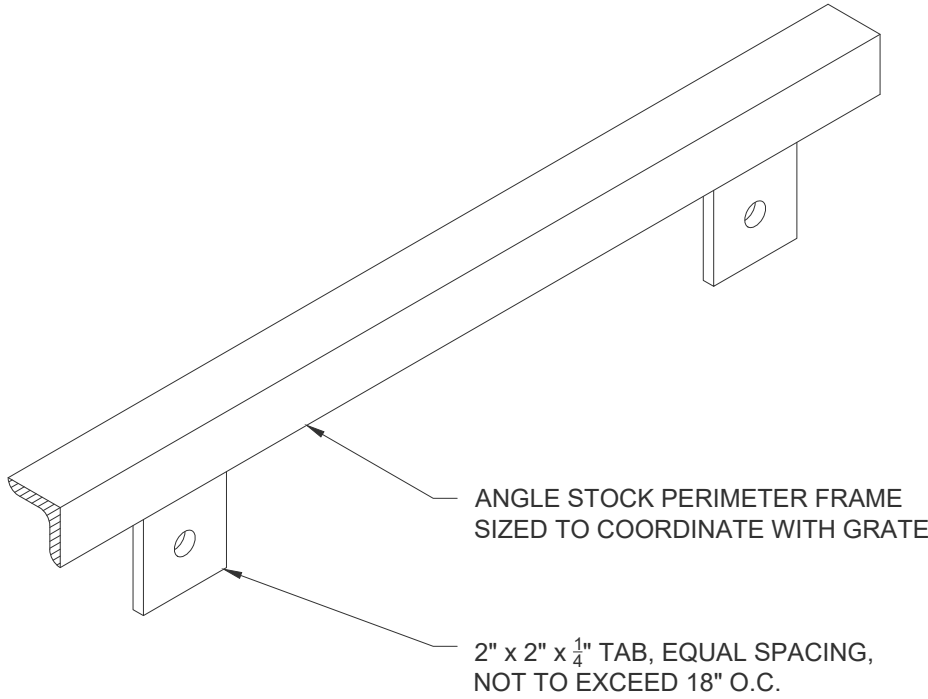

Type Inverted R - Isometric  
Scale: 3" = 1' 0"

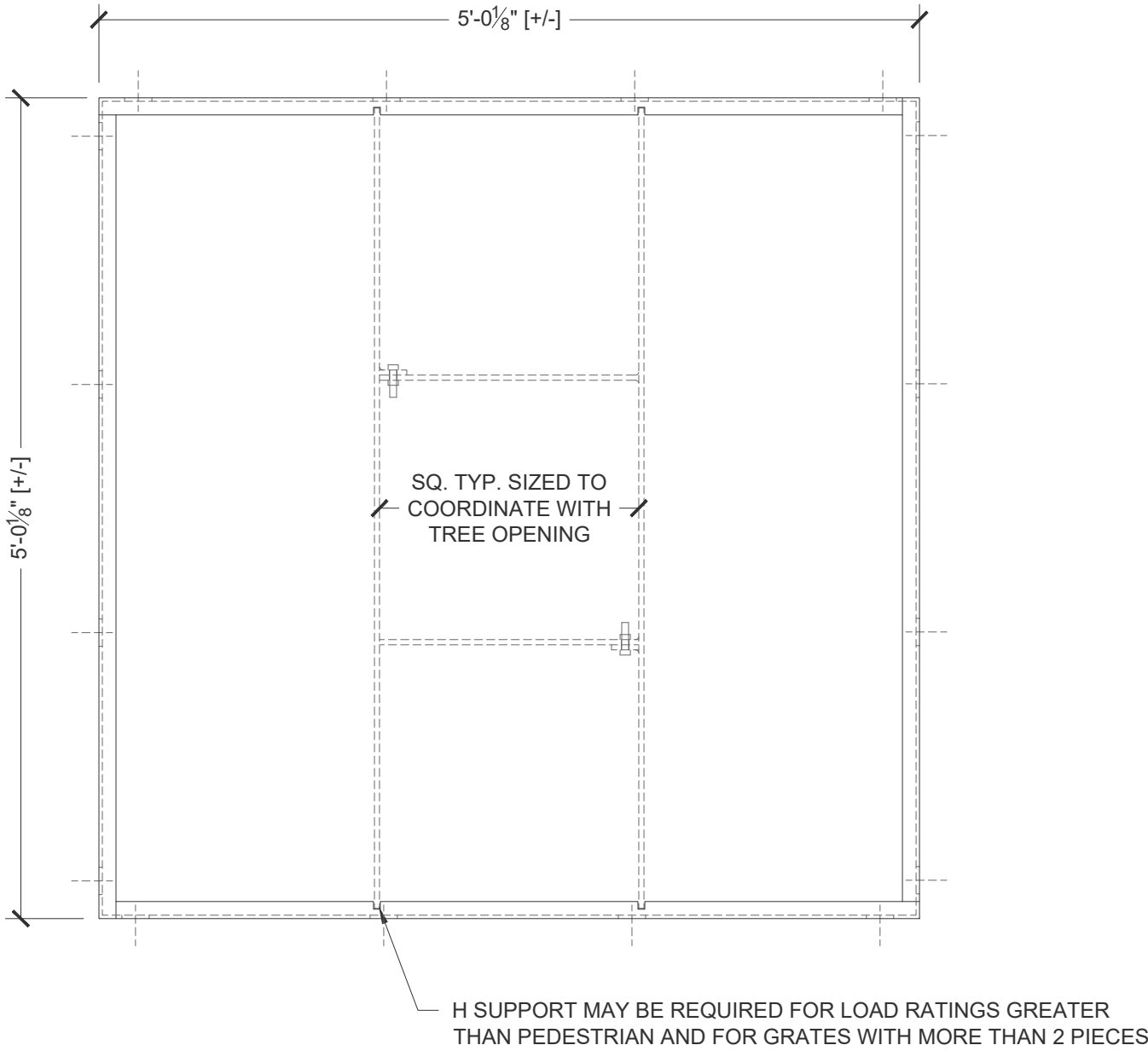

Example 5' Tree Grate Frame - Plan  
Scale: 1" = 1' 0"

URBAN ACCESSORIES

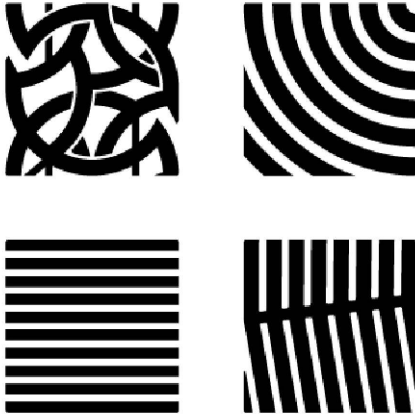

465 E 15th Street, Tacoma, WA 98421  
1.877.487.0488 | 1.253.572.1112

This print is the property of Urban Accessories, Inc. and is loaned to the recipient subject to be returned on demand. All contents herein are confidential and must not be copied or submitted to outside parties for examination without the express written consent of Urban Accessories, Inc.

If you received these documents in mistake please contact  
sales@urbanaccessories.com.

Project Name	Blank
Specified By	Blank
Sales Contact	sales@urbanaccessories.com
Project Location	Tacoma, WA
Page #	5 of 6

Additional Notes

GENERIC FRAME DETAILS

Typical for all frames

STANDARD SPECIFICATIONS

- Material will be high quality ASTM A36 mild steel (unless specified otherwise).
- Default finish will be natural patina of raw material (unless specified otherwise).
- Frames are load rated for pedestrian traffic only (Other load ratings available at request).
- Gap of 1/8" is typical between grate and interior frame edge. All visible edges are ground smooth on outside edges and are true to square or round. Top of grate to be flush with grade.
- Dimensions are nominal (sized to fit grates).

OPTIONS

Options listed below are available for all frames. Some options may not be available with certain load ratings or materials.

**Materials:**  
Stainless Steel, 304L  
Aluminum, 6061 T6  
Architectural Bronze

**Finishes:**  
Polyester Powder Coat  
Liquid coat (Specify color)  
Brush  
Polish  
Galvanized  
Other: \_\_\_\_\_ (With approval from UA)

**Load Ratings:**  
Light Vehicular (Medium Duty)  
H20/HS20 (Heavy Duty)

ADDITIONAL NOTES

- For specific details please contact your local rep or UA.
- PDFs and DWGs are available for all sizes of frames from your sales representative or by emailing sales@urbanaccessories.com

DRAWING INFO

Drawn By	NR
Date Drawn	3.19.2020

SPECS - TYPE A

- Type A frames are for non-permanent top mount installs into existing concrete w/ a surface treating that doesn't require fill containment, such as decking (for non-permanent frames with pavers use Type PA)
- Anchors are **NOT** provided by UA, anchors to be provided by installer prior to installation into concrete
- Tab sizes and overall height can be customized (additional specs will be required)
- For load ratings greater than pedestrian modifications to the frame may need to be made, for more information contact your rep or UA.

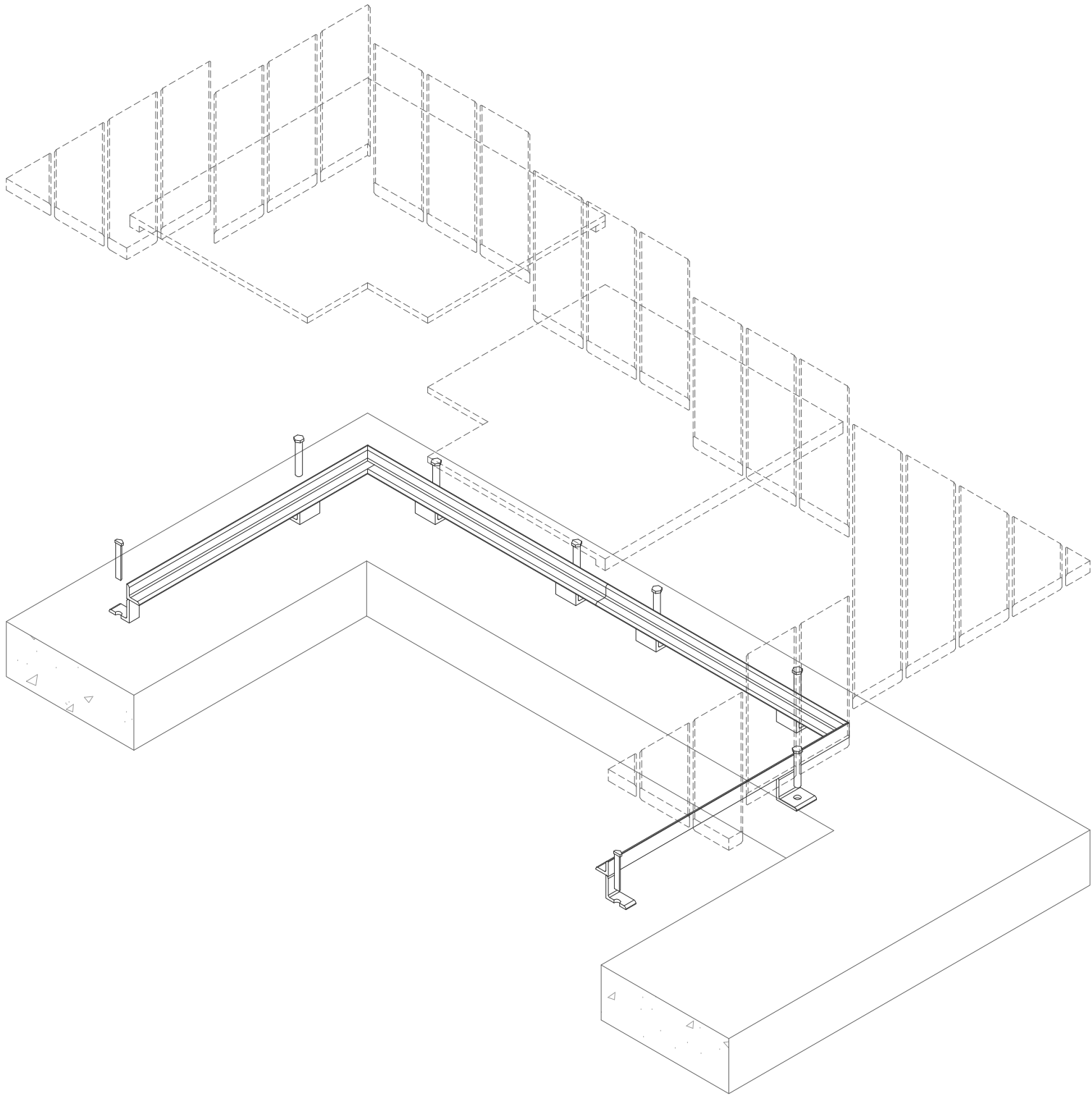

Type A - Exploded Assembly  
Scale: 1" = 1' 0"

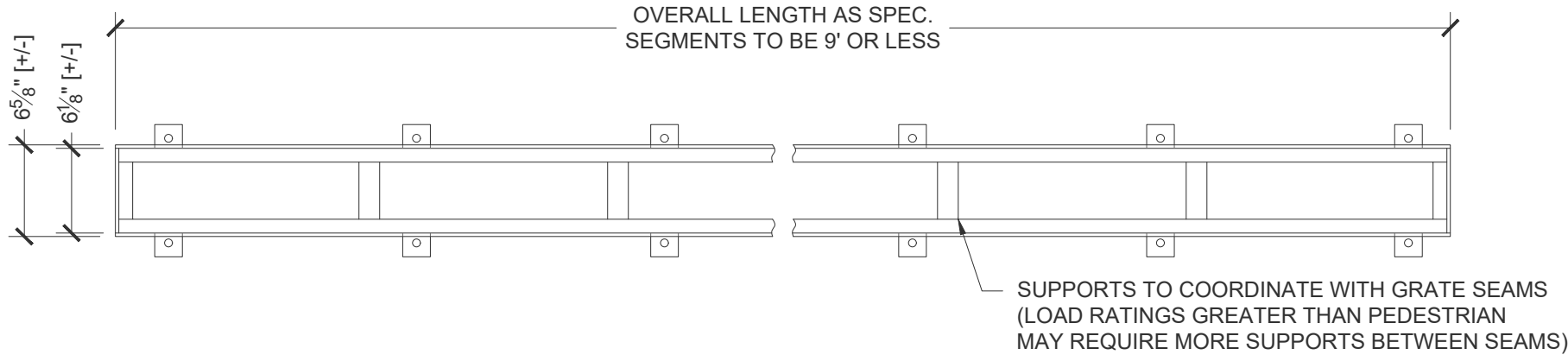

Example 6" Trench Frame - Plan  
Scale: 1" = 1' 0"

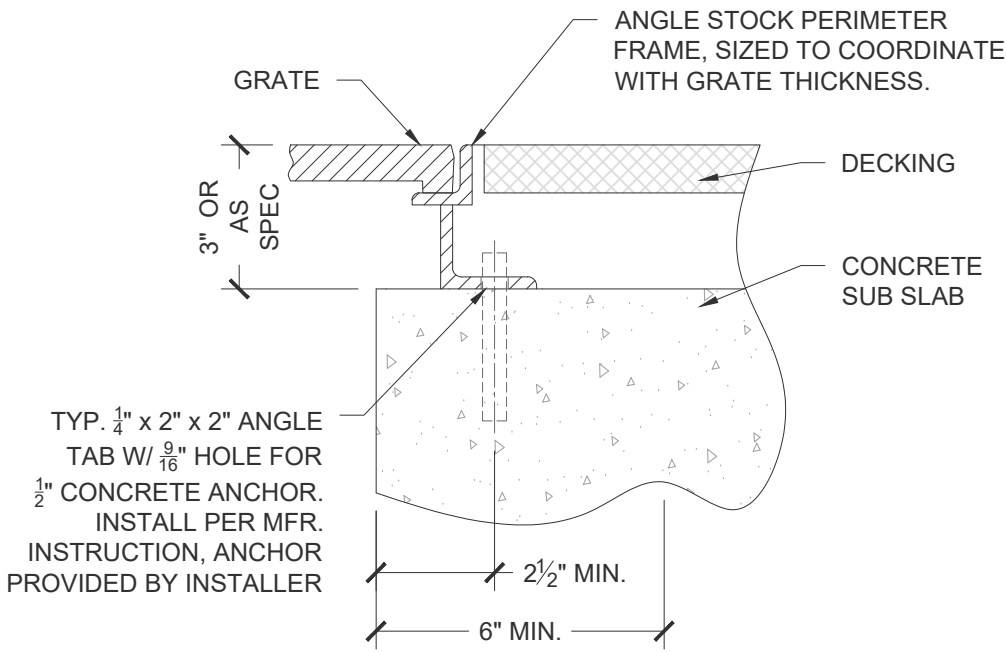

Type A - Section  
Scale: 3" = 1' 0"

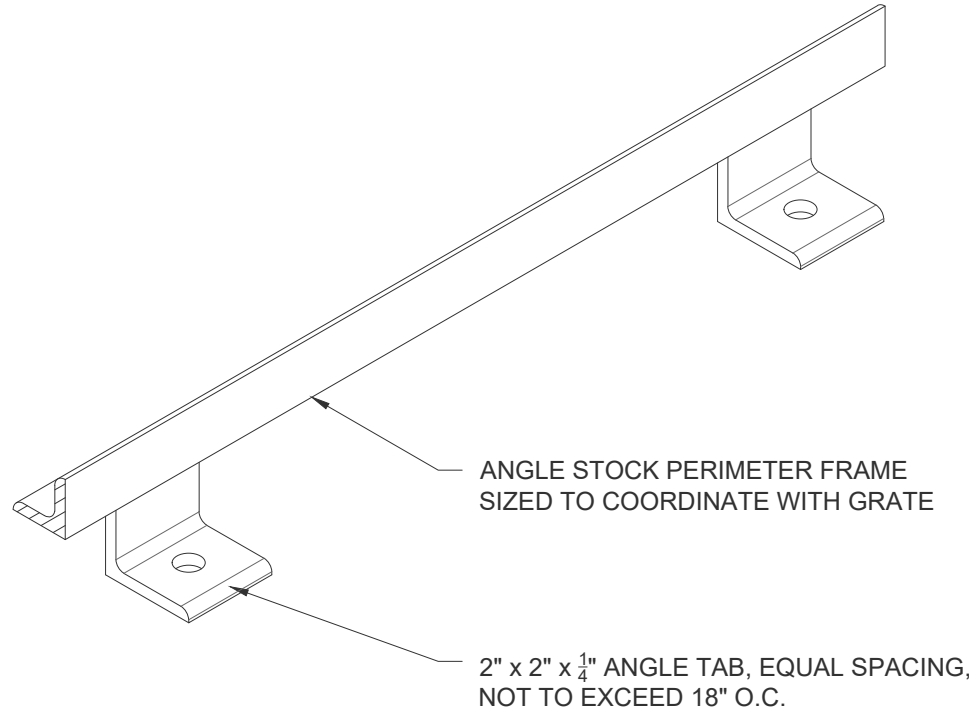

Type A - Isometric  
Scale: 3" = 1' 0"

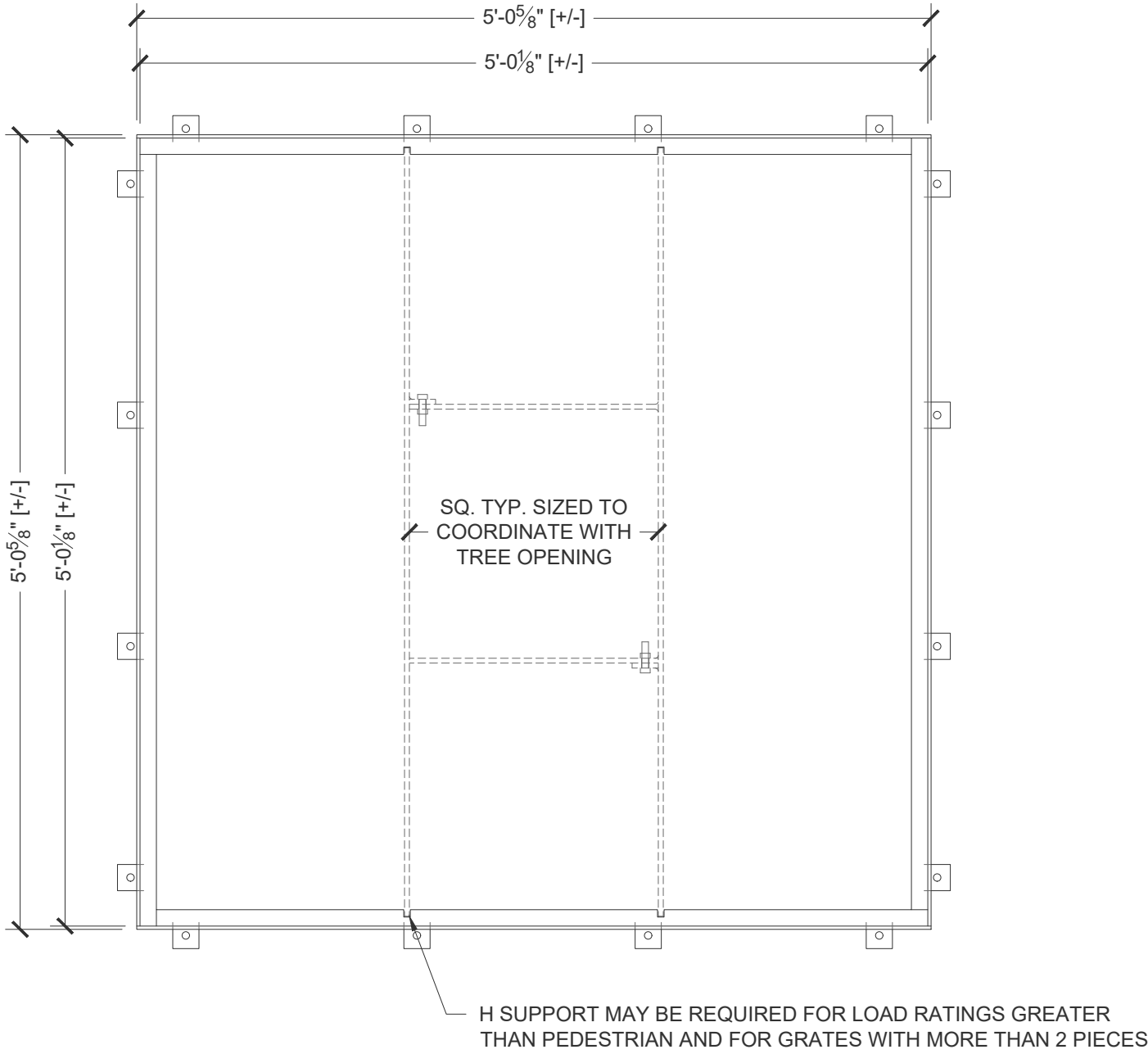

Example 5' Tree Grate Frame - Plan  
Scale: 1" = 1' 0"

URBAN ACCESSORIES

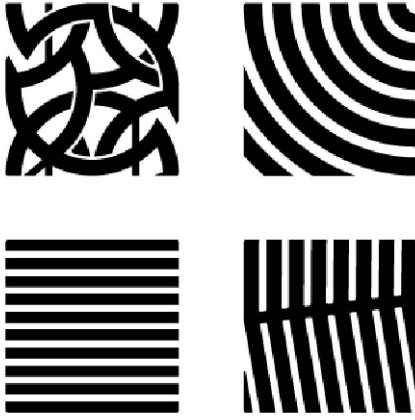

465 E 15th Street, Tacoma, WA 98421  
1.877.487.0488 | 1.253.572.1112

This print is the property of Urban Accessories, Inc. and is loaned to the recipient subject to be returned on demand. All contents herein are confidential and must not be copied or submitted to outside parties for examination without the express written consent of Urban Accessories, Inc.

If you received these documents in mistake please contact  
sales@urbanaccessories.com.

Project Name	Blank
Specified By	Blank
Sales Contact	sales@urbanaccessories.com
Project Location	Tacoma, WA
Page #	6 of 6

Additional Notes

GENERIC FRAME DETAILS

Typical for all frames

STANDARD SPECIFICATIONS

- Material will be high quality ASTM A36 mild steel (unless specified otherwise).
- Default finish will be natural patina of raw material (unless specified otherwise).
- Frames are load rated for pedestrian traffic only (Other load ratings available at request).
- Gap of 1/8" is typical between grate and interior frame edge. All visible edges are ground smooth on outside edges and are true to square or round. Tope of grate to be flush with grade.
- Dimensions are nominal (sized to fit grates).

OPTIONS

Options listed below are available for all frames. Some options may not be available with certain load ratings or materials.

- Materials:**  
Stainless Steel, 304L  
Aluminum, 6061 T6  
Architectural Bronze
- Finishes:**  
Polyester Powder Coat  
Liquid coat (Specify color)  
Brush  
Polish  
Galvanized  
Other: \_\_\_\_\_ (With approval from UA)
- Load Ratings:**  
Light Vehicular (Medium Duty)  
H20/HS20 (Heavy Duty)

ADDITIONAL NOTES

- For specific details please contact your local rep or UA.
- PDFs and DWGs are available for all sizes of frames from your sales representative or by emailing sales@urbanaccessories.com

DRAWING INFO

Drawn By	NR
Date Drawn	3.19.2020